

CUTTING EDGE 26



Residential Conference
22-24 June 2026

A silhouette of two rock climbers on a jagged rock face. One climber is on the left, pulling a rope, while the other is on the right, reaching out. The background shows a hazy mountain range under a sunset sky.

Equip:

**EMPOWERING OURSELVES
& OTHERS FOR MISSION**

KING'S PARK CONFERENCE CENTRE NORTHAMPTON

“

So they
strengthened
their hands for
the good work”

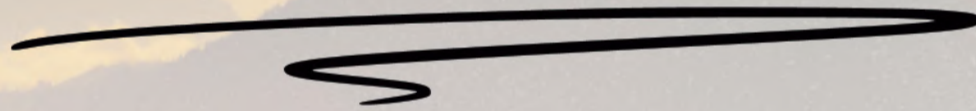

Nehemiah 2:18

ABOUT

What does it mean to be equipped for church leadership and mission today?

Join peers from across the UK as we explore leadership that helps us grow, empowers our teams, and enables mission.

Cutting Edge 2026 is a three-day residential conference in Northampton, packed with fellowship, teaching and equipping for Church Managers, Leaders and Senior Administrators.

With keynote sessions, seminars, worship, and opportunities to connect with others, you'll leave ready to strengthen and inspire your team, and make mission a reality in your church.

CONTENTS

Page 5	Conference FAQs
Page 6	Welcome to King's Park
Page 7	Venue Logistics
Pages 8-9	Programme
Page 10	Keynote Speakers
Pages 11-12	Seminars
Pages 13-16	Conference Sponsors
Page 17	Meet the Sponsors & Stallholders
Page 18	Altitude Training
Page 19	ILM Managing Church Well
Page 20	Churchworkers.net (CWN)
Page 21	UCAN Local Groups
Page 22	Bursary Fund
Page 23	UCAN Membership

CONFERENCE FAQs

WHERE DO I GO FOR HELP DURING THE CONFERENCE?

Our Conference Director is Gavin Smith. Please speak with Gavin about any specific help you need during the conference, or ask any other member of the UCAN or Cutting Edge Team (look out for the team badges). There will also be lots of opportunities throughout the conference for peer support in small group sessions and in break times.

ARE THERE ANY BOOKS OR RESOURCES FOR SALE?

10ofthose.com will be running a bookstall during the conference, with a number of titles available for purchase. There is also a small shop on site where you can purchase snacks, toiletries, books and gifts.

WHO ELSE WILL BE AT THE CONFERENCE?

We will have a number of representatives from various Christian based organisations who would love to chat to you and tell you about their services. You can find them at their stands in the main lounge during break times and their details are on the stallholder & sponsor pages of this booklet.

WELCOME TO KING'S PARK

[Click here for a more detailed floor plan](#)

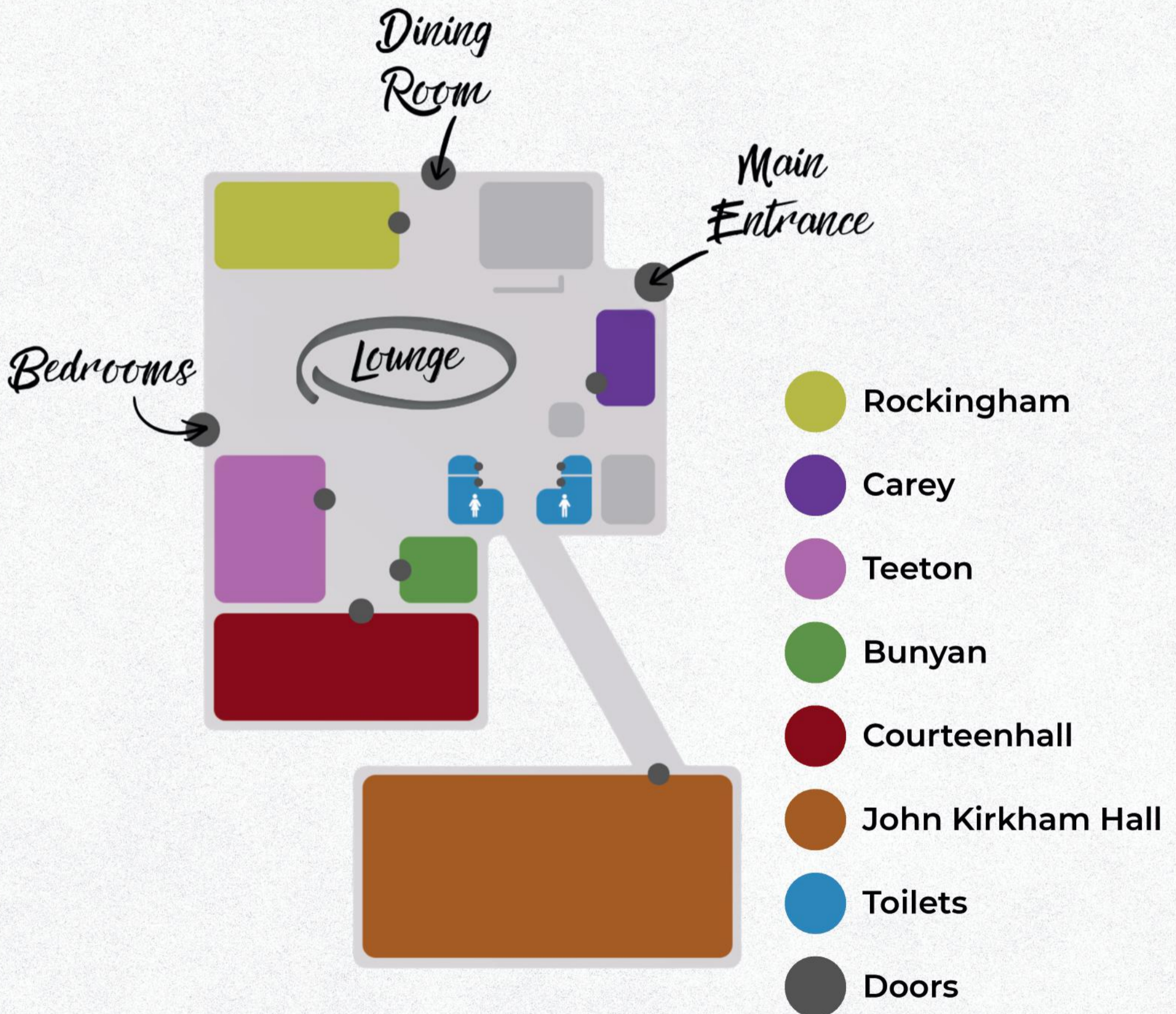

VENUE LOGISTICS

[Click here for further
guest information](#)

IMPORTANT INFORMATION

The venue is both alcohol free and non-smoking/non-vaping throughout. **Please do not bring any nut containing products onto the site.**

As a precaution, please don't leave valuables unattended, and keep your bedroom windows and door locked when you leave the room.

On day 3 (Wednesday), you'll need to vacate your room by 9:15am. If you do not have a car to store your luggage in, it can be stowed in the back right-hand corner of the main John Kirkham Hall.

The Centre reception is staffed from 8:00am until 10:30pm. If you need emergency assistance outside of these hours please contact Gavin.

If you would like to leave the centre before 8:00am or after 10:30pm you will need an access code to re-enter which is displayed on the reception desk.

WiFi access is available throughout the building via an open network. Access information is displayed around the building.

EXPLORING THE LOCAL AREA

If you want to leave the conference centre for some exercise or space, there is a perfect running / walking area directly south (2mins). Turn right as you leave the main drive and head to the end of Kings Park Road. [Click here for a map of the local area.](#)

MONDAY

- 12:15pm** Arrival and Registration
- 1:00pm** Lunch (with small group)
- 2:00pm** Introductions
- 2:30pm** Opening Worship & Prayer
- 3:00pm** THE WORK OF EQUIPPING:
Christ Gives Gifts to the Church
~ Mark Parsons
- 4:00pm** Break, Tea & Coffee
& room key pickup
- 4:30pm** Small Group Time
- 5:30pm** Seminar Slot 1
- 6:30pm** Dinner
- 7:30pm** Social/Quiz at

[The Lumbertubs](#) | ([MAP](#))

SEMINARS

- **Delegation That Actually Works**
- **Fundraising Skills That Enable Our Mission**
- **Better Meetings: Turning Talk Into Outcomes**
- **Sustainable Leadership: Managing Stress & Preventing Burnout**
- **Property & Practical Advice That Enable Our Mission**
- **Creating A Safe Environment For Those We're Enabling**
- **AI That Enables Others Into Mission**

SEMINAR CHOICES ARE FOUND ON YOUR PERSONALISED LANYARD
ALL KEYNOTE SESSIONS WILL BE IN JOHN KIRKHAM HALL

TUESDAY WEDNESDAY

- 8:30am** Breakfast
- 9:30am** Welcome & Worship
- 10:00am** BUILDING STRUCTURES AND PROCESSES THAT EQUIP THE CHURCH
~ Gavin Smith
- 11:00am** Break, Tea & Coffee
- 11:30am** OVERCOMING BARRIERS TO EQUIPPING YOURSELF & OTHERS
~ Jules Morgan
- 1:00pm** Lunch
- 1:30pm** Free time (*networking, meet the Sponsors & Stallholders, [local walks & attractions](#)*)
- 3:00pm** (Optional) Come & See
~ILM, Altitude, Local Groups & more
- 4:15pm** Small Group Time
- 5:15pm** Seminar Slot 2
- 6:30pm** Dinner
- 7:30pm** Local Church Update & Prayer
- 8:30pm** World Cup Football
at [The Lumbertubs](#) | [\(MAP\)](#).
(*England vs Ghana*)

- 8:30am** Breakfast
- 9:30am** Seminar Slot 3
- 10:30am** Break, Tea & Coffee
- 11:00am** LEADERSHIP THAT INSPIRES PEOPLE INTO ACTION
~ Penny Clarke
- PANEL DISCUSSION
- 12:00pm** Looking ahead for UCAN
~Worship
~Communion
- 12:45pm** Final thanks
- 1:00pm** Lunch & Depart

SMALL GROUPS

Space to pause, connect and reflect on the sessions.

Consider together how we can equip and empower ourselves and others in our church contexts.

You will be allocated a group upon arrival.

KEYNOTE SPEAKERS



GAVIN SMITH

Gavin has served as Church Manager for Christchurch, Newport for the last 22 years. He is passionate about the gospel and strengthening the church by supporting the work that happens behind the scenes. Gavin is also the founder of The Church Office, an online resource to support church leaders.

www.thechurchoffice.co.uk



PENNY CLARKE

Penny has over 10 years' experience in church Finance & Operations and now leads Finance & Operations for a UK Christian charity. She is passionate about the biblical basis for stewardship and management and teaches accounting, management and leadership to university students worldwide.



JULES MORGAN

Jules was a co-founding Director of UCAN when it launched as a non-profit in 2017 and she now oversees UCAN's CWN HR support service. She's Deputy Chief Executive of [BRF Ministries](#) and a senior consultant with the Wakeman Wright Group. Jules is also a non Executive Director with Alan Hirsch's 100M and 5Q movements and a Trustee of the UK mission charity SOMA.



MARK PARSONS

Mark has over 30 years of experience working in administration and operations for three different churches. He's currently the Operations Manager at Christ Church Clifton in Bristol, as well as being chair of the UCAN board. He was at the first ever Cutting Edge conference in 2010 and has been to every single one since!

SEMINARS

DELEGATION THAT ACTUALLY WORKS

Jules Morgan

Delegation is essential for healthy ministry growth, but it is not always easy to do well. In this practical seminar, [UCAN & CWN Managing Director and Consultant Jules Morgan](#) shares ways to empower volunteers and staff, remove bottlenecks and build healthy teams. You will leave with tools you can use straight away to strengthen leadership and reduce burnout.

FUNDRAISING SKILLS THAT ENABLE OUR MISSION

Andrew Clark

Every church has a mission worth supporting. This seminar offers practical tools to help you raise funds with confidence. [Andrew Clark from Action Planning & Church Grants](#) will share clear strategies for engaging supporters and encouraging generosity. Suitable for all levels of experience, you will leave with skills you can use straight away.

BETTER MEETINGS: TURNING TALK INTO OUTCOMES

Rachel Slough

Many meetings generate discussion but little clarity. In this practical seminar, [Leadership Consultant Rachel Slough](#), shares tools to help you plan with purpose, guide decisions and end with clear actions. You will leave with a simple framework to make meetings more productive.

AI THAT ENABLES OTHERS INTO MISSION

Ian Anderson Gray

Discover how AI can reduce admin, spark creativity, and empower your teams for mission. This practical session led by [AI Consultant, Ian Anderson Gray](#), introduces simple tools, real examples, and wise approaches to using AI in the life of the church.

SEMINARS

PROPERTY & PRACTICAL ADVICE THAT ENABLE OUR MISSION

Steve Wright

Church buildings are tools for ministry. In this seminar, [Steve Wright, Chief Executive for The Aquila Foundation](#), shares practical advice on managing and developing church property to support your mission. Covering compliance, maintenance and planning, this session will help you steward your facilities with confidence.

CREATING A SAFE ENVIRONMENT FOR THOSE WE'RE ENABLING

Manny Kemp

Safety is part of our duty of care. In this practical seminar, [Manny Kemp from ACAT](#) explains what churches need to know about health and safety and creating safe environments. You will receive clear guidance and practical steps to help keep your church compliant and welcoming.

SUSTAINABLE LEADERSHIP: MANAGING STRESS & PREVENTING BURNOUT

Rachel Slough

Leadership is rewarding but it can also be relentless. This seminar led by [Rachel Slough from Rachel Slough Consulting](#) offers practical tools to recognise stress, protect your energy and develop healthy rhythms. We will consider ways to set boundaries and support wellbeing within your team.

Check your
conference lanyard
for a reminder of
the seminars you
have signed up to



Streamline your Finances with **ExpensePlus**

Brilliant Fund Accounting Software Designed for Churches and Charities

- ✓ Digital Expenses & Approvals
- ✓ Automated Bank Reconciliation
- ✓ Drillable Financial Reports
- ✓ HMRC Gift Aid Integration
- ✓ ChurchSuite Export & much more!

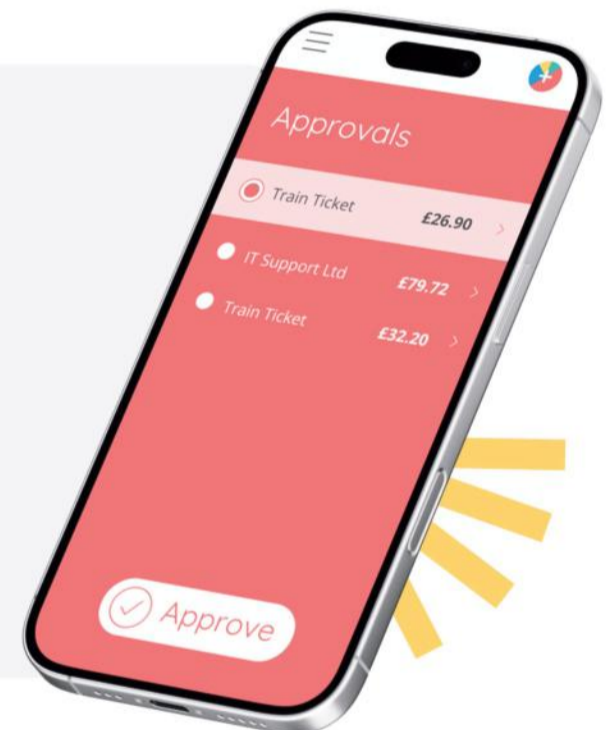

Easy to use



Quick to set up



Brilliant Help & Support

Google ★★★★★ with over 1000 user reviews

Find out more at expenseplus.co.uk



THE BRAND **NEW** DIGITAL LIBRARY OF BRF MINISTRIES

Including content from Anna Chaplaincy, BRF Resources, Messy Church, and Parenting for Faith

MEMBERSHIPS

Ministry

Audiobook

Full access

Small group



Courses



Audiobooks



Community



Small group resources



Webinars



Podcasts



brfonline.org.uk



Available on the App Store



GET IT ON Google Play



CSS Christian
Safeguarding
Services
Training & Consultancy Services



EQUIP AND EMPOWER YOUR CHURCH TO DEVELOP BEST PRACTICE IN SAFEGUARDING

Our passion is to help churches approach safeguarding from a **biblical foundation**

WE CAN HELP YOU WITH:



Developing safeguarding policies, procedures and systems



Training your staff and volunteers



Processing DBS checks



Creating a strong, positive safeguarding culture



Providing expert consultation and ongoing support



EXPERIENCED & TRUSTED

All our staff have extensive professional experience in the safeguarding field and are Christians actively involved in local churches



TAILORED TO YOU

We offer a flexible and comprehensive range of services, adaptable to your unique situation



0116 218 4420



contact@thecss.co.uk



thecss.co.uk



When your team thrives so does your ministry

Health, wellbeing & leadership support for UK churches and mission agencies

We're a team of doctors, psychologists, coaches and consultants that provides a range of medical, psychosocial, OH support and trainings to help your ministry thrive.

"Everyone in public ministry should ...hear what Thrive has to say."

— John, Chelmsford Diocese

- Occupational Health
- Medicals for Faith Leaders
- Counselling
- Coaching
- Leadership Support
- Mediation
- Starting Well In Church Ministry

www.thrive-worldwide.org

ThriveWorldwide



SPONSORS & STALLHOLDERS

MONDAY-WEDNESDAY

- BRF MINISTRIES
- CHRISTIAN SAFEGUARDING SERVICES
- NATIONAL SUPPORT FROM THE CHURCH OF ENGLAND
- 10 OF THOSE

TUESDAY ONLY

- CHURCHSUITE
- MG EVENT & SOUND
- EXPENSE PLUS
- DIGITAL OCEAN OUTREACH
- KINGDOM BANK
- JOVO

SUPPORTING FROM AFAR
THRIVE WORLDWIDE

FIND OUT MORE ABOUT THE CONFERENCE
SPONSORS & STALLHOLDERS HERE

ELEVATE YOUR CHURCH LEADERSHIP SKILLS

...through a CPD accredited, peer-learning course, with professional coaching support



Altitude Training has been absolutely amazing; the content is incredibly engaging and relevant.

If you're looking to elevate your leadership skills through a deeper understanding of yourself, then this is the course for you. It's brilliantly practical, reflective, encouraging, and supportive.

**MARK STEEL | ADMINISTRATION TEAM LEADER
SUTTON COLDFIELD BAPTIST CHURCH**

[CHURCHADMINISTRATORS.NET/TRAINING](https://churchadministrators.net/training)



Sarah Cooper

Head of Operations | The Beacon Church

“ The course was very beneficial to me, and gave me clarity and strategies to move forward in my role.

It is worth the time out of the office to do, and it will hugely benefit your working life and confidence. ”

[CHURCHADMINISTRATORS.NET/TRAINING](https://www.churchadministrators.net/training)



**CHURCH
WORKERS**
.net

Being part of Churchworkers.net as well as UCAN is like having another piece in the Ops & Admin systems jigsaw, allowing me to operate and run a church office efficiently...

The more churches that sign up...the less time we will all be trying to reinvent the wheel and the more time we can invest into kingdom building.



JANE HIGGINBOTTOM

Head of Operations, St Chad's, Romiley

UCAN LOCAL GROUPS

Invest in your vital ministry today by joining one of our many Local Groups for Church Administrators across the United Kingdom.

UCAN Local Groups are a safe place and confidential forum to pray for one another, to share challenges and chat over conundrums!

Gather with your peers to exchange ideas, share wisdom and be encouraged! With Senior Manager groups in Surrey, Manchester & the West Midlands.

FIND COMMUNITY, RESOURCES AND INSPIRATION



Find your nearest group!

[CHURCHADMINISTRATORS.NET/LOCALGROUPS](https://churchadministrators.net/localgroups)

*(No group in your area? Could you help get one started?
Speak to Maria or Verity for more details!)*

Give TO UCAN

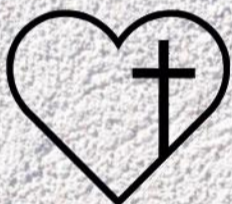

Give to our **General Fund** and support the vision and mission of UCAN, as we seek to serve and equip churches and administrators across the UK

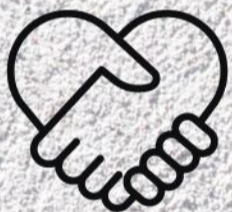

Give to our **Bursary Fund** and bless other church administrators with limited funding, so they too can access UCAN membership, training and conferences

We'll be taking a cash free offering, via an online giving page, in our closing worship on Wednesday. Please give generously if you are able.

Thank you!

[CHURCHADMINISTRATORS.NET/GIVE](https://churchadministrators.net/give)

- **Choose your preferred fund from the drop down menu!**
- **Make a regular or one off donation!**



EMPOWERED MISSION NEEDS EQUIPPED ADMINISTRATORS

Don't just take our word for it! Watch our video below and hear directly from our members about how UCAN serves them and their church

Equip your administrators with the tools, resources and community they need to succeed with UCAN

[CHURCHADMINISTRATORS.NET/JOIN](https://churchadministrators.net/join)

EQUIPPED TO SERVE, EMPOWERED FOR MISSION

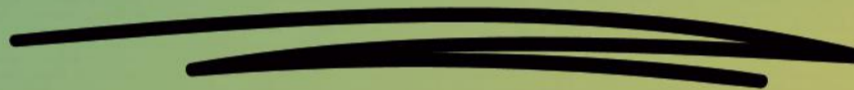

UCAN IS THE UNITED KINGDOM CHURCH ADMINISTRATORS NETWORK,
A NOT FOR PROFIT ORGANISATION (COMPANY NO. 10660800)

OUR REGISTERED OFFICE (BUSINESS MAILING ONLY):

 27 OLD GLOUCESTER STREET, LONDON, WC1N 3AX

 INFO@CHURCHADMINISTRATORS.NET

 0300 302 1887

