

2 0 2 2



AT A L O G U E



KORTEL DESIGN

KORTEL DESIGN

KORTEL

KORTEL DESIGN is a French brand of paragliding harness and accessories created in 1999.

Located in the foothills of Mont Blanc, *KORTEL DESIGN* designs and develops products with an attention to details and functionality that has cemented its reputation as one of the leaders in the world.

Comfort, efficiency, innovation and quality are the keywords from specifications to validation of the latest prototypes. Nothing is left to chance...





DESIGN

For the best customer experience, *KORTEL DESIGN* relies on a network of trained resellers, guaranteeing optimum service.

KORTEL DESIGN is above all a team of dedicated folks at your service, gathered around the single purpose of offering innovative and high-quality products, adapted to your type of flying.

High-tech products, designed by and for happy pilots!

SOMMAIRE

Harnesses	p.5
Backpacks	p.17
Cockpits	p.24
Parachutes	p.27
Connectors	p.29
Accessories	p.30
Clothes	p.35
Accastillage	p.38





HARVESTES

Karma III

Progression harness

	XS	S	M	L	XL
Pilot (cm)	<160	<170	<185	<190	>190
Weight (kg)	---	---	3,50	---	---
Certification	EN 1651 & 12491 / LTF / CE				

- Back and bottom airbag
- Airbag shaping structure
- Large back pocket
- Seat board
- Twin inflation scoop
- All adjustments are flight accessible
- Roll damping adjustable independantly from the front belt spacing
- Dual locking reserve container

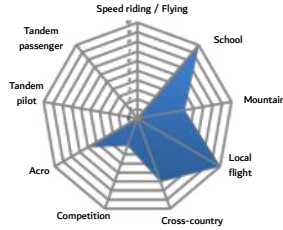

Sold with : Reserve handle / 20mm automatic carabiners / 2-bar speedbar

The Karma III follows your progress, from small morning flights to your first cross! The acclaimed Karma II geometry was redesigned to make it even lighter and more compact, without sacrificing protection since its integral airbag provides a complete protection all the way to the top of the back. The shaping of the lower part using nitinol rods yields an effective protection seconds after take-off. With its flight-adjustable roll damping system, the stability of the harness can be adapted to the weather conditions in flight. The reserve container 2-level closure system prevents accidental deployment if the handle is caught. Its adjustable volume allows it to adapt to the model of the reserve parachute.



KARMA III



Kuik III

Versatile harness

Sold with :

Harness-only option: 20mm automatic carabiners / 2-bar speedbar / footrest

Cocoon Harness option: Reserve handle / 20mm automatic carabiners / 3-bar speedbar

	S	M	L	XL
Pilot (cm)	<170	<185	<190	>190
Weight (kg)	3,00	3,20	3,35	3,50
Cocoon weight (kg)	1,10	1,20	1,30	1,40
Total weight (kg)	4,10	4,40	4,65	4,90
Certification	EN 1651 & 12491 / LTF / CE			

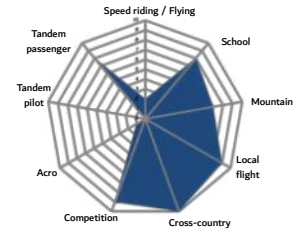

- Back and bottom airbag
- Reversible harness Sak-Airbag
- Large back pocket
- Three-way inflation scoop
- All adjustments are flight accessible
- Roll damping adjustable independantly from the front belt spacing

The KUIK III is a versatile leisure harness, intended for both the site pilot, the aspiring cross-racer, or the hike-and-fly amateur. Its multiple storage pockets allows you to get started in bivvy-flying. The 3D molded seat design provides exceptional comfort for this kind of harness, providing hours of flight time without of any pain. The seat composed of split thigh structure provides perfect leg support. The geometry of the harness has been designed to accurately transmit the air mass, while maintaining efficient and intuitive control. Equipped with a latest generation reversible airbag, you just need to flip it to have a comfortable carrying bag. Need to go further? The removable cocoon option transforms the Kuik III into a cross-country harness. Equipped with an integrated rescue container, you have the perfect harness to explore new horizons.



KUIK III

Kanibal Race II

THE reference in competition!

- Speedbar winch pulleys
- Adjustable anchor height
- Inflatable rear airfoil
- Anti-forget closure system integrated to the cocoon
- Double back container reserve parachute
- Variable stabilization system (adjustable ABS)
- Back protection foam-bag (certified)
- System to reduce leg tension inside the cocoon
- Drag chute pocket with central attachment, right/left access

	S	M	L	XL
Pilot (cm)	<167	<183	<188	>188
Weight (kg)	7,2	7,5	7,8	8,1
Certification	EN 1651 & 12491 / LTF / CE			

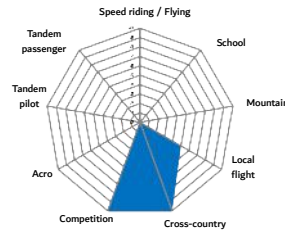

Supplied with : Pin-lock carabiners / Adjustable 3 step speed-bar / Dyneema lines / Double rescue kit (risers - handles) / Removable cockpit



The Kanibal Race II has been designed with a single goal in mind: performance! Pure performance by optimizing the aerodynamic drag with a rear airfoil producing the most tolerant flight polar, reducing the pilot's fatigue thanks to an exceptional comfort, optimizing the wing's dynamic behavior thanks to its unique stabilization system which adjusts the stability according to the flight phase, enhancing the pilot's strategic choices with a cockpit to carry the top of the line flight instrumentation.



Get into a competition bucket seat with its unique back support system that provides full and even back support, even in a prone position.

The double emergency container (right and left access) meets FAI requirements.

The inflatable profile optimizes aerodynamics and helps control yaw movements.



Kanibal Race II ST

THE reference in cross-country!

	S	M	L	XL
Pilot (cm)	<167	<183	<188	>188
Weight (kg)	7,2	7,5	7,8	8,1
Certification	EN 1651 & 12491 / LTF / CE			

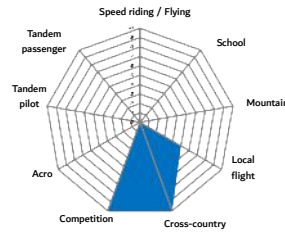

- Speedbar winch pulleys
- Adjustable anchor height
- Inflatable rear airfoil
- Anti-forget closure system integrated to the cocoon
- Double back container reserve parachute
- Variable stabilization system (adjustable ABS)
- Back protection foam-bag (certified)
- System to reduce leg tension inside the cocoon
- Drag chute pocket with central attachment, right/left access

Supplied with : Pin-lock carabiners / Adjustable 3 step speed-bar / Dyneema lines / Double rescue kit (risers - handles) / Removable cockpit

Embedding all the technical developments of the Kanibal Race II such as flight-adjustable dynamic stabilization, exceptional comfort like bucket seat, the large instrument-holder cockpit, and the double reserve container, the ST version is stands out with its shorter rear stabilizer which allows better rear visibility.

This more discreet look will suit pilots looking for a top-performance harness to consider the most ambitious cross-country flights , and to achieve them! The inflatable rear profiler can easily be replaced by that of the Kanibal Race II, for a "competition" look and increased aerodynamic performance.



Kolibri EVO

- Hybrid protection foam bag / airbag (395g)
- Large storage volumes
- Connection to the wing via "T-Bone Links".
- First aid pocket on the front of the Kocon
- Dyneema yarn structure
- All adjustments via unique splice system
- Telescopic poles holder in rear pocket
- Double sided air intake scoop
- Carbon nose ring

Light cocoon harness for bivouac flight

	M	L	XL
Pilot (cm)	<170	170<185	>185
Weight (kg)	1,9	2,0	2,1
Certification	EN 1651 & 12491 – LTF - CE		

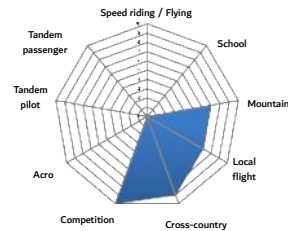

Modifications compares to the Kolibri :

- Anti-snap reserve handle
- Openable left thigh, from the Kolibri PRO
- Mesh pocket under the reserve container, for external batteries
- Connection possible with light carabiners
- Sliding shoulder system, for better take-off comfort
- Integrated connection for all types of reserve risers
- Cocoon closure integrated with the reserve riser connection

Supplied with : Rescue risers / Rescue handle / Soft-links / Light speed-bar

The Kolibri EVO is our lightweight harness for hike and fly competition, or bivouac flight.

The result of 7 years of experience, the Kolibri EVO maintains all the features that have made the reputation of the Kolibri since 2014, and adds improvements and novelties that still make it the gold standard of lightweight cocoon harnesses.

It remains unbeatable in the niche of bivouac and expedition flights due to its unparalleled comfort and its large storage capacity.

Its independent leg structure makes it more progressive in roll than a hammock-type harness, which translates into greater peace of mind for the pilot in difficult conditions. Its unprecedented comfort for a harness of this weight, makes it usable on flights lasting several hours. The frontal reserve, integrated into the cocoon, is very easy to extract, even under strong acceleration. The handle falls naturally in your hand.



"Konnect" system reserve connection



Cocoon closure



Front mesh pocket



Openable thigh



Light carabiner connection

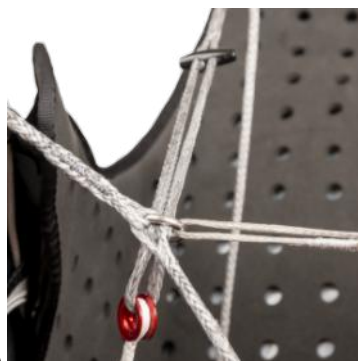

Sliding shoulders



T-Bone links supplied as standard



New ergonomic reserve handle

NOTE:

All the improvements made on the Kolibri EVO can be carried out on the old Kolibri. For more information, contact us on info@korteldesign.com



koncept

School harness

	XS	S	M	L	XL
Pilot (cm)	<160	<170	<185	<190	>190
Weight (kg)	3,78	3,8	3,86	3,9	3,94
Certification	EN 1651 & 12491 / LTF / CE				

Supplied with : Rescue risers / Front container and Rescue handle / Automatic carabiners 20mm / XS seatplate + 2 additional seatplates (choice of sizes)

A morphology outside of the typical norms ?

A body shape defying the "standards" ?

The Koncept is the first fully adjustable harness from XS to XL!

Each and every setting can be independently modified to fit the harness to your unique body shape.

Designed and developed to enhance the paragliding learning phase, the harness is equipped accordingly :

- Fully certified airbag
- Removable protective tarp
- Back tilt adjustment
- Removable rescue front container
- Chest belt with anti-forget system
- Holster with radio holder integrated in the chest strap (option)

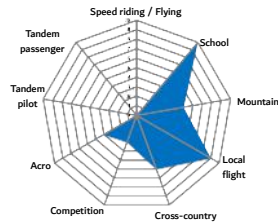

- Back and bottom airbag
- Pre-inflated fstructure
- Small pocket on the top of the harness
- Front removable rescue container
- Triple inflation scoops
- Speedbar accessories
- Chest belt with anti-forget system

Available seatplates: XS / S / M / L / XL
(Available per unit)



K-Flex

**Tandem passenger harness
Adjustable – 1m50 to 2,05m !**

Fully adjustable harness :

- Seat width
- Height of anchor points
- Length of the back
- Side handles for take-off aid
- Removable cleaning tarp
- Anti-forget frontal strap
- Large back pocket, and bottom protection by preformed airbag equipped with 2 side air scoops.

Supplied with : Automatic carabiners 40mm

You never have the right size harness for your passenger?
Are your students struggling in a harness that's too big or too small for them?
The K-Flex is THE solution!
Suitable for all body sizes, from 1.50m to 2m.
Multiple use: tandem passenger, school slope, first big flights, ...

	Unique size
Pilot (cm)	150<205
Weight (kg)	3,1
Certification	EN 1651 & 12491 / LTF

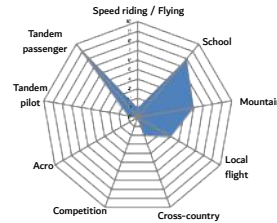

Kid

**Kids tandem passenger harness
Adjustable – 80cm to 1m50 !**

Fully adjustable child harness :

- Seat width
- Seat depth
- Height of anchor points
- Length of the back
- Anti-forgetful frontal strap
- Back pocket, and bottom protection by foam bag

Supplied with : Automatic carabiners 40mm

What a joy to fly children in tandem!
BUT what a pain to find a harness adapted to their morphology ...
The Kid is THE solution!

	Unique size
Pilot (cm)	80<150
Weight (kg)	1,9
Certification	EN 1651 / CE

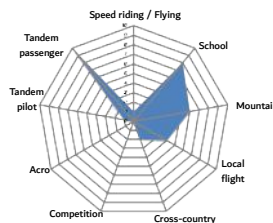

Kliff II

Mountain / Trail running

- 3D shaping.
- Dyneema structure
- Openable leg system
- Connection of the glider integrated in the harness
- Back tilt adjustment by splices
- Pre-equipped for speed-bar with LFR

	S	M	L	XL
Pilot (cm)	155<168	168<180	180<192	192<205
Weight (g)	185	190	195	200
Certification	EN 1651			

Supplied with : Storage pocket

The Kliff II features the 3D molded geometry! This technology offers unbelievable comfort for such a lightweight harness, and makes it possible to be one with the harness. It is the only harness that can connect directly to the glider without carabiners! It is also equipped with the exclusive "Konnect" buckle system.

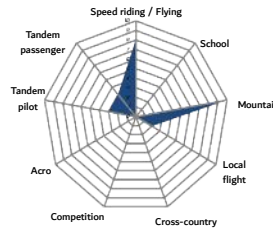

Krayer III

Mountain harness

- Dynema structure
- Openable leg system
- Shoulder rescue connection
- Adjustable belly strap
- Possibility to connect the Sak III (reversible airbag)
- Pre-equipped for speed-bar with LFR

	S	M	L	XL
Pilot (cm)	155<168	168<180	180<192	192<205
Weight (g)	335	340	375	405
Certification	EN 1651			

Supplied with : Soft connectors T-Bone Links (20g/pair)

The Krayer III has been reworked and now incorporates the moulded 3D geometry! This technology offers unbelievable comfort for a harness of this weight. It is also equipped with the exclusive "Konnect" buckle system.

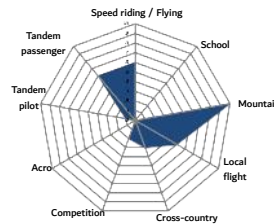

Karver II

Multi-purpose harness

- Interlocking lumbar and thigh belt buckles
- Reliable loops in all conditions (snow, sand, etc)
- Possibility of connecting the Sak II (reversible airbag)
- Speedbar ready
- The Sak II brings more comfort and handling to the harness.
- Possibility of connecting the tandem module, to transform the Karver II into a tandem pilot harness.

	S	M	L	XL
Pilot (cm)	<160	160<183	180<190	>190
Weight (g)	775	840	945	1050
Certification	EN 1651			

Supplied with : Automatic carabiners 40mm

The Karver II copies the concept of the shoulderless harness initiated with the Karver. This concept has proven its potential in terms of comfort, safety and riding pleasure. It has evolved towards less weight, more comfort and simplicity, but it also becomes modular, like the Krayer II with which it shares the attachment system that allow to connect the tandem module.

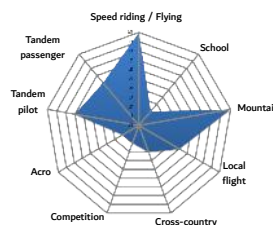







BACKPACKS & COCKPITS



Tandem module

Tandem pilot module

- 5-point quick release clip
- Top pocket for small items
- Kontainer for tandem rescue light
- Bottom pocket for the tandem bag
- 10cm protective foam (650g / removable)
- Right or left rescue handle
- 2 lateral connections providing additional lumbar adjustment (comfort and handling precision)

	Unique size
Weight (kg)	1,35
Certification	CE
Compatibility	Kruyer II / Karver II

Supplied with : Rescue handle / Bump air 10cm



Harness, spacers and carabiners not included

The tandem module enables you to transform the Karver II into a light tandem pilot harness, giving it the possibility to carry a light tandem reserve parachute. It also has a 10cm protective foam, as well as a storage pocket for the tandem bag.

Sak II

- UNIQUE: Improved comfort and handling of the harness
- Easy connections
- Side net pockets
- Excellent carrying comfort
- Top flap pocket, which becomes an internal storage pocket independent of the airbag
- Possibility to lock the upper part of the airbag for tandem passenger use
- Mounting for telescopic sticks, in mounted position and in airbag position (flight)

**KARVER II & KRUYER II
COMPATIBLE**



	Unique size
Volume (L)	60
Weight (g)	975
Certification	EN 12491 / LTF / CE
Compatibility	Kruyer II / Karver II

Supplied with : rain cover

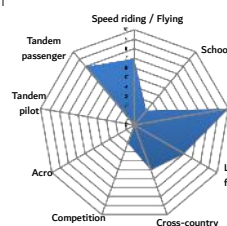

Poles and ice axe not included

The Sak II is a reversible airbag. It is compatible with the Karver II and offers an excellent carrying comfort for a minimum weight. It is more than just an airbag as it also improves the comfort and handling of compatible harnesses, in addition to providing good passive safety thanks to its airbag function.

Sak III

- UNIQUE: Improved comfort and handling of the harness
- Easy connections
- Side net pockets
- Excellent carrying comfort
- Top flap pocket, which becomes an internal storage pocket independent of the airbag
- Possibility to lock the upper part of the airbag for two-seater passenger use
- Mounting for telescopic sticks, in mounted position and in airbag position (flight)

KRUYER III COMPATIBLE



Harness not included

	SM	ML
Volume (L)	70	
Weight (kg)	1	
Certification	EN 12491 / LTF / CE	
Compatibility	Kruyer III	



The Sak III is the new reversible airbag by Kortel Design. It is compatible only with the Kruyer III . Its volume has increased compared to version 2, for use with standard site wings. Just like version 2, its installation on the Kruyer III improves lumbar support with the associated adjustment. This also improves the harness support when thermalling hard. The airbag function always provides additional passive safety.

Sak Race II

The Sak Race II was designed for the Kanibal Race II. Its volume has been specially designed to carry the Kanibal Race II, a competition wing, and many critical accessories (instruments, helmet, ballast, jacket, ...). Its very high shape gives it an excellent carrying capacity, yet still respects the folding instructions of the wing and lines.



- Load carrying straps
- Compression straps
- Zipped side pocket
- Weight: 1.45kg
- Volume: 220 L

Ballast bag Reversible

Reversible bag for transporting ballast. Can be worn as a bag, or connected to the shoulder straps of the Race II bag on the chest. Fits directly into the ballast pocket of the Kanibal Race II.

Ballast pocket not included



Shoulder bag

- Small tote bag
- Carried with a shoulder strap



Tandem bag II

- The capacity of the bag (200l) allows you to store the tandem wing, the pilot's harness and its reserve, two helmets, as well as the passenger's harness assuming it doesn't have a bulky foam bag.
- Wide abdominal strap. Height adjustable chest strap
- 1 drawstring, and 2 side compression straps
- Excellent portability due to its compactness
- Side pocket for telescopic pole
- Ergonomic carrying straps
- Small zip pocket

	Unique size
Weight (kg)	1,5
Volume (L)	200



(*) Subject to availability

The Tandem Bag II is the latest evolution of the pouffe bag invented by Kortel Design many years ago. The carrying has been further improved thanks to its ergonomic straps and its compactness which will make it the best friend of your back!



K27

The Sak K27 is ideal for single-day hike and fly, with mini-wings or ultra-light wings.

With its "vest" carrying mode, it is particularly suitable for a fast walk, and even for running using its front strap which then gives it perfect stability on the back.

Its internal folding cover lets the wing adapt to the shape of the bag, and preserves storage space for the rest of the flight equipment (jacket, gloves, etc.).

Its multiple pockets gives you quick access to your water bottles, your smartphone, a neck gaiter or small gloves.

	Unique size
Weight (g)	440
Volume (L)	27

- Trekking pole holder
- Removable helmet holder
- Zipped top pocket
- Load transfer straps
- Integrated folding sock
- Shoulder strap mesh pockets, for soft water bottles
- Internal waterproof protection against perspiration



Water bottle holder



Trekking pole holder

Removable helmet holder



Integrated internal folding cover

Sak K40

	Unique size
Weight (g)	650
Volume (L)	40

The Sak Kolibri 40l has been designed for mountain lovers. Ideal for your day trips, whatever the summit you are aiming for!

- Net pockets on straps, for cans and/or small equipment
- Back shaping slat
- Waterproof internal protection against perspiration
- Mounting for telescopic sticks or ice-axe
- Numerous side mesh pockets, accessible while walking
- Top zip pocket
- Load transfer strap
- Compression straps
- Removable helmet holder



Sak K60

	Unique size
Weight (g)	700
Volume (L)	60

The Sak Kolibri 60l was designed for lovers of hike&fly competitions or those who use their light equipment on a daily basis, for whom the Sak Kolibri 80l is too bulky.

- Net pockets on straps, for cans and/or small equipment
- Back shaping slat
- Waterproof internal protection against perspiration
- Unique zip to open all or part of the bag
- Numerous side mesh pockets, accessible while walking
- Water pocket hose passage
- Top zip pocket
- Load transfer strap



Supplied with : Rain cover



Sak Kolibri

	Unique size
Weight (g)	800
Volume (L)	80

The Sak Kolibri has been thought and designed for hike&fly and vol-bivouac enthusiasts. It integrates the necessary and essential functions for this type of practice.

- Protective veil cover, according to the size of the bag
- Net pockets on straps, for cans and/or small equipment
- Waterproof internal protection against perspiration
- Unique zip to open all or part of the bag
- Numerous side mesh pockets, accessible while walking
- Unique system for compressing the sail in the bag
- Hands-free system to hold the poles during the walk (GPS, telephone, etc ...)
- Back shaping slat
- Water pocket hose passage
- Top zip pocket
- Load transfer strap



Option : Extension
(Details page 31)

Supplied with : Rain cover / Folding bag



Cockpit Safe



- Instrument cockpit compatible with all types of harnesses, with anti-forget connection system
- 4L capacity pocket.
- Adjustable cockpit inclination
- Upper velcro space for instruments
- Rigid cover for post-flight instrument protection
- Quick-access top camera slot

Cockpit Extension



Increases the instrument support area for light harnesses with small integrated cockpit

- Security ring
- Safety carabiner
- Velcro connection
- Adjustable tilt
- Padded protective pouch



Instrumentation non included

Cockpit Kanibal Race II



- Removable instrument cockpit dedicated to the Kanibal Race II
- Large surface for positioning flight instruments
- Built-in sun shield for better screen readability
- Compartment for external batteries, with power cable feed-throughs
- Storage pocket for various objects
- Reversible into a small bag with handle for storing and transporting instruments



Container V4



- Container compatible with types of harnesses
- Allows the installation of a reserve parachute in frontal position.
- Compatible with our Krisis range of reserve parachutes.
 - S -> For 2.8L to 3.3L reserve volume
 - L -> For 3.3L to 5.0L reserve volume
- Elevator guide sleeve, removable
- New riser/harness interface by "Konnect" system
- A retaining strap prevents pendulum movements.
- Double emergency handle, for right or left hand gripping



Supplied with : Removable sheath

Container Cockpit



- Instrument cockpit adaptable to all types of harnesses.
- Upper velcro space for instruments.
- Spare pocket (max volume 5L), with compression straps.
- Compatible with Krisis, Rogallo II and Karre rescues.
- Anti-forget connection, "Konnect" system.
- Elevator guide sleeve, removable

Supplied with : Removable sheath



Instrumentation non included







PARACHUTES

CONNECTORS & ACCESSORIES

Krisis Karre

Stearable square rescue

	KARRE 100	KARRE 125	KARRE 160	KARRE 220
PTV Max (kg)	100	125	160	220
Weight (kg)	1,17	1,39	1,78	2,52
Volume (L)	3,9	4,7	5,3	7,3
Sink rate (m/s)	4.6 m/s at 100 kg - 3.6 m/s at 70 kg	4.5 m/s at 125 kg - 3.5 m/s at 85 kg	4.8 m/s at 160 kg - 3.5 m/s at 110 kg	4.6 m/s at 220 kg - 3.6 m/s at 160 kg
Certification	EN / LTF			

The brand new Kortel Design rescue parachute, the Karre, has 3 main innovations compared to the competition:

- The unique design of the Karre generates a horizontal speed after opening, which creates lift, thus significantly improving the sink rate.
- This horizontal speed also provides a glide ratio of about 1.5, which allows the pilot to steer the parachute thanks to the handle system, and thus avoid potential obstacles during descent.
- the asymmetrical shape induces a fold which improves the opening speed, without making the packing more complex.

The Karre is deliberately folded "aerated" in a wide container, as this improves the extraction and opening by facilitating the air intake. It is quite possible to fold it in a more compact way by using the smaller container size.

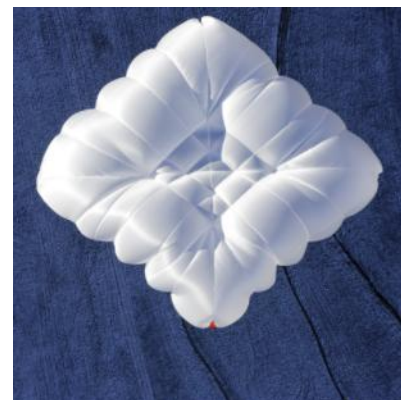

Krisis Rogallo II

Stearable rescue

	Rogallo II 130
PTV Max (kg)	130
Weight (kg)	1,84
Volume (L)	4,9
Sink rate (m/s)	3,8
Certification	EN / LTF

The Krisis Rogallo is the pilotable rescue parachute in the Kortel Design product line. It benefits from an innovative system allowing it to behave like a hemispherical parachute immediately after opening, i.e. a stable vertical descent with a sufficiently low speed. Thus, in case of opening at very low altitude, the pilot only has to manage drop-and-roll- landing, without worrying about possible complications. This safe behaviour is only possible thanks to the large surface area of the Krisis Rogallo.



Pod Krisis KARRE

Sold individually



	Color std Pod	Color round Pod (*)
Karre 100		
Karre 125		
Karre 160		
Karre 220		

(*) Round pod for insertion in a frontal container

Pod Krisis UL

Pod color

UL 80	
UL 95	
UL 115	
UL Tandem	

Sold individually



Pod Krisis Rogallo II

Rogallo II 130
Rogallo II 130 Light
Rogallo II 100 Light



Carabiner 40mm

Sold in pair



- For 40 mm straps
- Material: Aluminium
- Labelled Kortel Design
- Side opening
- Resistance: >2000daN
- Weight: 120g per pair

Soft-Links

Sold in pair



- Soft connectors
- Resistance: >2300daN (in duplicate)
- Material: Dynema Ø3mm halyards
- Weight: 10g per pair

Carabiner 20mm

Sold in pair



- For 20 mm straps
- Material: Aluminium
- Labelled Kortel Design
- Side opening
- Resistance: >2400daN
- Weight: 130g per pair

T-Bone Links

Sold in pair



- Soft Dyneema connector
- Konnect" high-speed connection
- Resistance: >2400daN
- Weight: 20g per pair

T-Bone "XL"

Available soon



- Soft Dyneema connector
- Konnect" high-speed connection
- Resistance: >3000daN
- Weight : 29g

Quick links



Sold individually



Delta



Oval



Square

	MRDI04.0	MRDI06.0	MRNI07.0	MRNI06.0	MRCI07.0
Material	Stainless Steel	Stainless Steel	Stainless Steel	Stainless Steel	Stainless Steel
Wire diameter (mm)	4,0	6,0	7,0	6,0	7,0
Shape	Delta	Delta	Delta	Oval	Carré
WLL (kg) *	200	450	625	650	625
CR (kg) *	1000	2250	3125	3250	3125

* WLL = Working Load Limit / CR = Failure Load



T-Bone Link

Double speed-bar



- First flexible bar
- Adjustment pads
- Second rigid bar
- Split hooks included
- Weight: 110g

Triple speed-bar



- Ideal for cocoon harnesses
- Adjustment pads
- Flexible materials
- First adjustable bar
- Split hooks included
- Weight : 80g

Kit Ronstan



- Sold in pair
- Winch Ronstan pulleys
 - Dyneema lines 5mm

Double light speed-bar



- Dyneema Lines
- Adjustment pads
- No split hooks
- Locking cord
- Weight: 25g

Triple light speed-bar



- Ideal for light cocoon
- Adjustment pads
- Flexible materials
- No split hooks
- Locking cord
- Weight: 25g

Kit Cordelettes



- Sold in pair
- Polyester/Dyneema 5mm
 - Simple connexion
 - Length: 130cm
 - Weight : 57g per pair

Rescue risers light



- Sold in pair
- Single-strand light lift
 - Dyneema structure
 - Built-in "Konnect"
 - Length: 120 cm
 - Weight: 60g per pair

Bridles protection



- Sold in pair
- Protect the bridles
 - Opening by explosive zip
 - Weight : 125g

Kit Cordelettes



- Sold in pair
- Polyester/Aramid 7mm
 - Better restraint
 - Simple connection
 - Length: 135cm
 - Weight: 90g per pair

Kit extension Rogallo II



- Allows to compensate the difference in height between links and fasteners shoulder

Tandem rescue risers



Rescue risers



- Emergency lift light "Y"
- Dyneema structure
- Length: 120 cm
- Weight: 90g



Rescue handles



Wood plate



- For harnesses:
- Kanibal Race 1
 - Kamasutra II
 - Karma / Karma II

S / M / L / XL

Carbon plate



- For harnesses:
- Kanibal Race 1
 - Kamasutra II
 - Karma / Karma II

XS / S / M / L / XL

Carbon footplate PVC



- For harnesses :
- Kanibal Race II
 - Kanibal Race II ST
 - Kolibri / Kolibri EVO
 - Kuik II module cocon

K-Flex tarp



- Protects the airbag from external influences.
- Removable and washable
- Can be fixed by velcro

Kool tarp



- Protects the airbag from external influences.
- Removable and washable
- Can be fixed by velcro

XS = Purple / S = Yellow / M = Red / L = Green

Carbon ring



- For harnesses :
- Kolibri / Kolibri EVO
 - Kuik II module cocon

Cocon protection Kolibri / Kolibri EVO



- Avoids rubbing the cocoon during acceleration
- Available in S / M / L

Dorsal battens

- Spare dorsal battens for Kanibal Race II / Kanibal Race II ST
- Material: Triplex

Water ballast



- Volume : 15L

Rear tail Kanibal Race II & ST



- Inflatable rear tail for Kanibal Race II and Race II ST
- Zip mounting
- Available in S / M / L / XL

Foot stirrup



- Karma II compatible and Kuik II Krashbox
- Quick-release system
- Accelerator connection elastic
- Weight: 95g

Extension sak Kolibri



- For sak Kolibri
- Capacity: 20 L
 - Removable
 - Zipped pocket

Actioncam pocket



- Adaptable to any harness
- Adjustable length
- Padded protection

Holster



Radio not included

- Adaptable to any harness
- Stretchable pocket
- For radios with size close to: 100x60x35mm

Foam bag 10cm



- Suitable, in addition to the 7cm foam bag, for :
- MB Kuik II Module / Kanibal Race 1 / Kamasutra II / Kanibal
- Suitable alone for :
- Tandem module
- Thickness : 10cm

Foam bag 7cm



- Suitable, in addition to the foam bag 10cm, for :
- MB Kuik II Module / Kanibal Race 1 / Kamasutra II / Kanibal
- Thickness : 7cm



Rigid tandem spreader



No more straps that disrupt the checklist at take-off!

The integrated sheath guides and protects the reserve risers and its connection. In case of opening, the explosive zip allows an instant release of the rescue risers to the connection point. The zip also allows a quick check of the rescue connection.

The innovative design of the tandem connection to the tandem canopy limits the pitching movements of the passenger.

- 2 passenger hanging heights
- Supplied with a T-Bone XL (p29) for rescue connection.
- Material: Dyneema / Aluminium / Carbon
- Built-in sheath
- Weight: 440g per pair

Soft tandem spreader



Lightweight in design, these soft spreaders lighten your tandem equipment.

The integrated sheath guides and protects the rescue risers and the connection of the rescue parachute. In case of opening, the explosive zip allows instant release of the rescue risers to the connection point. The zip also allows a quick check of the rescue connection.

The passenger's anchorage height can be adjusted thanks to the adjustable splicing system, exclusive to Kortel Design.

- Height-adjustable passenger seat height
- Supplied with a T-Bone (p29) for emergency connection.
- Material: Dyneema
- Integrated sheath
- Weight: 170g per pair







CLOTTHERS
& ACCASTILLING

Snap-back

85% acrylic 15% wool



Black



Royal

Navy

Burgundy

Cap

87% cotton 13% polyester



Royal



Mustard

Navy



Black

Burgundy

Tank Top

XS / S / M

- Tight fit
- 100% organic cotton
- Fairwear Foundation® label



-  Ocean green
-  Burgundy



T-shirt

S / M / L / XL

- Unisex fit
- Short sleeves, round neck
- 100% organic cotton
- Fairwear Foundation® label

-  Ocean green
-  Grey chine



Hoodie

S / M / L / XL

- Unisex fit
- 85/15 Cotton Bio / recycled polyester 350g
- Fairwear Foundation® label

-  Night blue
-  Wooden chine



T-shirt TEAM

XS / S / M / L / XL



- Unisex fit
- Short sleeves, round neck
- 100% organic cotton
- Fairwear Foundation® label

-  Royal Blue
-  Black
-  Pink Punch

Hoodie TEAM

XS / S / M / L / XL



- Unisex fit
- 85/15 Cotton Bio / recycled polyester 350g
- Fairwear Foundation® label

-  Royal Blue
-  Black



Neckband

- Kortel Design neckband
- Ideal in the bottom of the bag
- Multiple possibilities of use



Soft-shell jacket



- Softshell jacket: lightweight and windproof
- Color blue "Kortel"
- 3 pockets including 1 chest
- Men's model available in sizes XS, S, M, L, XL
- Women's model available in sizes XS, S, M, L



Low friction ring

In addition to the contact diameter, the quality of friction is directly related to the quality of anodization.

Our rings are made of a grade of aluminium chosen for its anodisation ability, in addition to its mechanical properties. It is the one that allows the greatest thickness of hard anodizing, guaranteeing the longevity and quality of the rings. We therefore increase to 50 microns of hard anodizing.

- Low-friction aluminium rings
- Anodising hard 50m or coloured
- Wide range of sizes

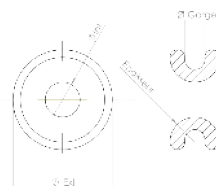

	Ø external (mm)	Ø internal (mm)	Ø gorge (mm)	Wall thickness (mm)	Recommended line size (mm)	Surface treatment
LFR 10-3,5 (*)	10	3,5	2	1,5	2/2	Hard anodising 50µm
LFR 11,5-5,5 (**)	11,5	5,5	3	1	3,5/3	Hard anodising 50µm
LFR 16-6 (*)	16	6	4	1,5	4/4	Hard anodising 50µm
LFR 16-8 Black (**)	16	8	4	1	6/4	Hard anodising 50µm
LFR 16-8 Orange (**)	16	8	4	1	6/4	Anodising 10µm
LFR 16-8 Green (**)	16	8	4	1	6/4	Anodising 10µm
LFR 16-8 Red (**)	16	8	4	1	6/4	Anodising 10µm
LFR 20,5-10 (**)	20,5	10	5	1,5	8/5	Hard anodising 50µm
LFR 24,5-14 (**)	24,5	14	6	1,5	11/6	Hard anodising 50µm
LFR 26-9 (*)	26	9	8	2	7/8	Hard anodising 50µm
LFR 30,25-18 (**)	30,25	18	7	1,75	15/7	Hard anodising 50µm
LFR 32-12 (*)	32	12	9	3	9/9	Hard anodising 50µm
LFR 50-20 (*)	50	20	14	4	15/14	Hard anodising 50µm
LFR 62-30 (**)	62	30	17	5	23/17	Hard anodising 50µm
(1) LFR 65-34 (**)	65	34	8	5	27/16	Hard anodising 50µm
(1) LFR 70-28 (*)	70	28	20	6	21/20	Hard anodising 50µm

* Pulley range: up to 180° angle, thick material for maximum strenght

** Guiding range: up to 135° angle, thinner wall, higher inner diam/outer diameter ratio, weaker under heavy load

(1) On order, minimum 100 pieces

NOTE:

All LFRs are available by default in black hard anodized. There is no such thing as coloured hard anodizing. On request, we can study a colourless hard anodizing and a non-hard coloured anodizing.

Nonoss V2

Nonoss V2 29-5-8



- V2 aluminium Nonoss
- Coloured anodising 10m

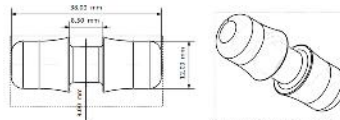

Nonoss V2 15-5-8



Nonoss V2 38-9-12



	Length (mm)	Ø gorge (mm)	Gorge width (mm)	Shoulder (mm)	Surface treatment
Nonoss V2 15-5-8 Black	15	5,1	5	8	Anodising 10µm
Nonoss V2 29-5-8 Green	29	5,1	8	8,4	Anodising 10µm
Nonoss V2 29-5-8 Orange	29	5,1	8	8,4	Anodising 10µm
Nonoss V2 29-5-8 Red	29	5,1	8	8,4	Anodising 10µm
Nonoss V2 38-9-12 Red	38	9	8,5	12	Anodising 10µm

Aluminium ring

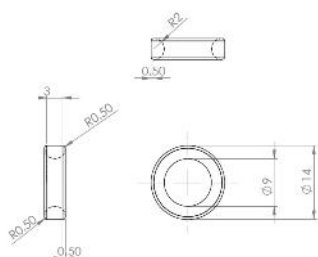

Ring 56-30-16

- Aluminium guide rings
- 50µm hard anodising or coloured single anodising



Ring 14-9-4

	Ø external (mm)	Ø internal (mm)	Wall thickness (mm)	Internal radius (mm)	Chamfer (mm)	Surface treatment
Anneau 14-9-4 Black	14	9	4	2	0,5	Hard anodising 50µm
Anneau 14-9-4 Orange	14	9	4	2	0,5	Anodising 10µm
Anneau 14-9-4 Green	14	9	4	2	0,5	Anodising 10µm
Anneau 14-9-4 Red	14	9	4	2	0,5	Anodising 10µm
Anneau 23-15-4 Black	23	15	4	2	0,5	Anodising 10µm
Anneau 56-30-16 Black	56	30	16	7	4	Hard anodising 50µm

NOTE:

All rings are available by default in black hard anodized. There is no such thing as coloured hard anodizing. On request, we can study a colourless hard anodizing and a non-hard coloured anodizing.







APPENDICES

SIZING GUIDE

Sizing Guide

Kolibri EVO



		Taille pilote (cm)									
		155	160	165	170	175	180	185	190	195	
Poids pilote (kg)	50	M	M								
	55	M	M	M							
	60	M	M	M	M						
	65	M	M	M	M	L					
	70	M	M	M	M	L	L				
	75	M	M	M	L	L	L	L			
	80	M	M	L	L	L	L	L	XL		
	85		L	L	L	L	L	L	XL	XL	
	90			L	L	L	L	XL	XL	XL	
	95				L	L	XL	XL	XL	XL	
	100					XL	XL	XL	XL	XL	
	105						XL	XL	XL	XL	

Kanibal Race II - ST



		Taille pilote (cm)											
		150	155	160	165	170	175	180	185	190	195	200	
Poids pilote (kg)	50	S	S	S									
	55	S	S	S	S								
	60	S	S	S	S	S							
	65	S	S	S	S	M	M						
	70	S	S	S	M	M	M	M					
	75		S	M	M	M	M	M	M				
	80		M	M	M	M	M	M	L	L			
	85			M	M	M	M	L	L	L	L		
	90				M	M	L	L	L	L	L	L	XL
	95					L	L	L	L	L	L	XL	XL
	100						L	L	L	XL	XL	XL	XL
	105							L	XL	XL	XL	XL	XL
	110								XL	XL	XL	XL	XL



Kuik III

		Taille pilote (cm)										
		150	155	160	165	170	175	180	185	190	195	200
Poids pilote (kg)	50	S	S	S								
	55	S	S	S	S							
	60	S	S	S	S	S						
	65	S	S	S	S	M	M					
	70	S	S	S	M	M	M	M				
	75		S	M	M	M	M	M	M			
	80		M	M	M	M	M	M	L	L		
	85			M	M	M	M	L	L	L	L	
	90				M	M	L	L	L	L	L	XL
	95					L	L	L	L	L	XL	XL
	100						L	L	L	XL	XL	XL
	105							L	XL	XL	XL	XL
	110								XL	XL	XL	XL

Karma III

		Taille pilote (cm)										
		150	155	160	165	170	175	180	185	190	195	200
Poids pilote (kg)	50	XS	XS	XS								
	55	XS	XS	XS	S							
	60	XS	XS	XS	S	S						
	65	XS	XS	S	S	S	M					
	70	S	S	S	S	M	M	M				
	75		S	S	M	M	M	M	M			
	80		M	M	M	M	M	M	L	L		
	85			M	M	M	M	L	L	L	L	
	90				M	M	L	L	L	L	L	XL
	95					L	L	L	L	L	XL	XL
	100						L	L	L	XL	XL	XL
	105							L	XL	XL	XL	XL
	110								XL	XL	XL	XL

Koncept



		Taille pilote (cm)										
		150	155	160	165	170	175	180	185	190	195	200
Poids pilote (kg)	50	XS	XS	XS								
	55	XS	XS	XS	S							
	60	XS	XS	XS	S	S						
	65	XS	XS	S	S	S	M					
	70	S	S	S	S	M	M	M				
	75		S	S	M	M	M	M	M			
	80		M	M	M	M	M	M	L	L		
	85			M	M	M	M	L	L	L	L	
	90				M	M	L	L	L	L	L	XL
	95					L	L	L	L	L	XL	XL
	100						L	L	L	XL	XL	XL
	105							L	XL	XL	XL	XL
	110								XL	XL	XL	XL

LIFF II



		Taille pilote (cm)										
		150	155	160	165	170	175	180	185	190	195	200
Poids pilote (kg)	50	S	S	S								
	55	S	S	S	S							
	60	S	S	S	S	S						
	65	S	S	S	S	M	M					
	70	S	S	S	M	M	M	M				
	75		S	M	M	M	M	M	M			
	80		M	M	M	M	M	M	L	L		
	85			M	M	M	M	L	L	L	L	
	90				M	M	L	L	L	L	L	XL
	95					L	L	L	L	L	XL	XL
	100						L	L	L	XL	XL	XL
	105							L	XL	XL	XL	XL
110								XL	XL	XL	XL	

ruyer III



		Taille pilote (cm)										
		150	155	160	165	170	175	180	185	190	195	200
Poids pilote (kg)	50	S	S	S								
	55	S	S	S	S							
	60	S	S	S	S	S						
	65	S	S	S	S	M	M					
	70	S	S	S	M	M	M	M				
	75		S	M	M	M	M	M	M			
	80		M	M	M	M	M	M	L	L		
	85			M	M	M	M	L	L	L	L	
	90				M	M	L	L	L	L	L	XL
	95					L	L	L	L	L	XL	XL
	100						L	L	L	XL	XL	XL
	105							L	XL	XL	XL	XL
110								XL	XL	XL	XL	

arver II



		Taille pilote (cm)										
		150	155	160	165	170	175	180	185	190	195	200
Poids pilote (kg)	50	S	S	S								
	55	S	S	S	S							
	60	S	S	S	S	S						
	65	S	S	S	S	M	M					
	70	S	S	S	M	M	M	M				
	75		S	M	M	M	M	M	M			
	80		M	M	M	M	M	M	L	L		
	85			M	M	M	M	L	L	L	L	
	90				M	M	L	L	L	L	L	XL
	95					L	L	L	L	L	XL	XL
	100						L	L	L	XL	XL	XL
	105							L	XL	XL	XL	XL
110								XL	XL	XL	XL	



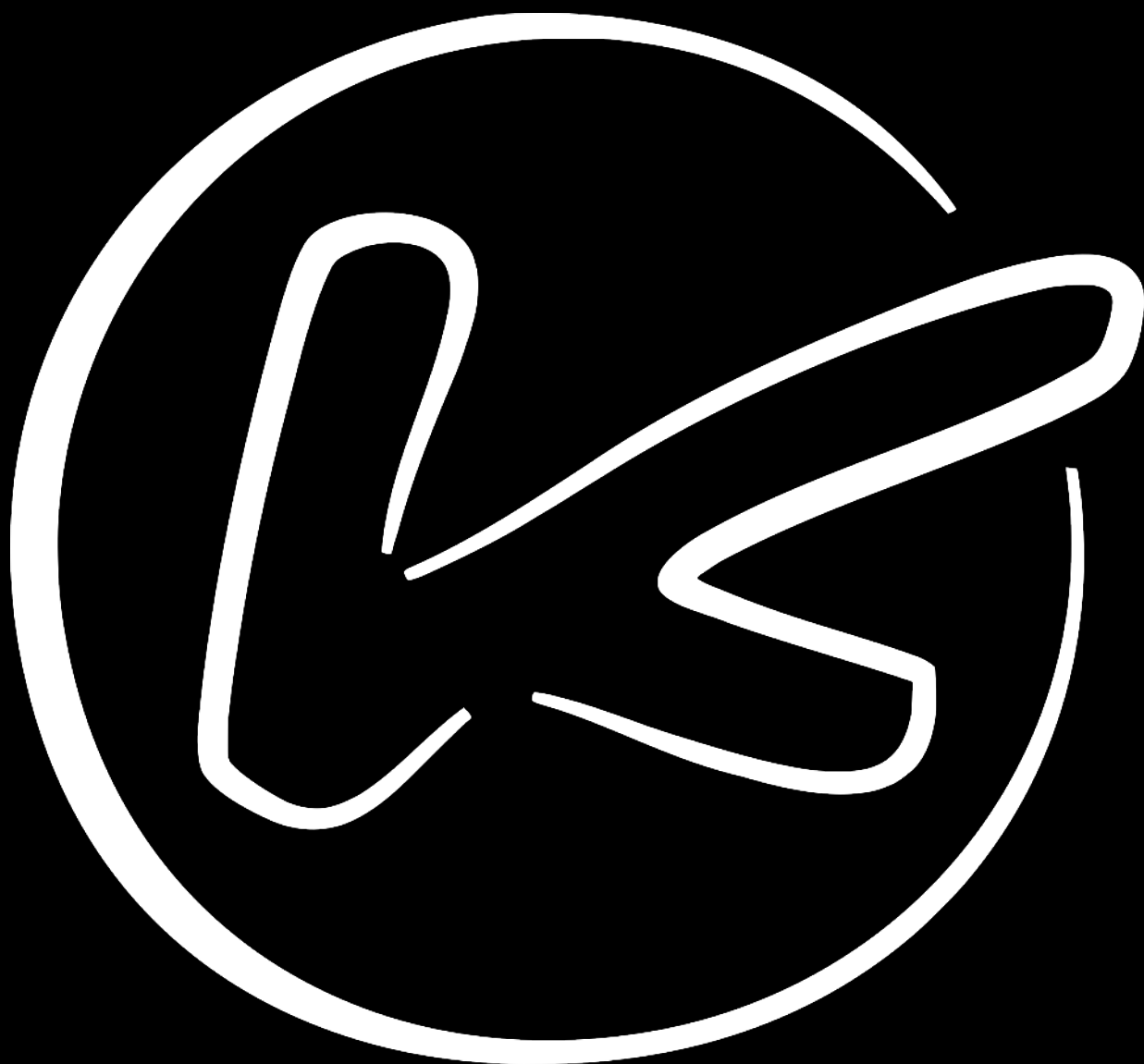

KORTEL DESIGN

+33 (0)9.50.10.73.27 - info@korteldesign.com
1096 av. A. Lasquin - 74700 SALLANCHES - FRANCE