



HILTON ARUBA CARIBBEAN RESORT & CASINO MEETING AND EVENT FACTS

AT A GLANCE

- Designated AAA four-diamond resort
- Located just 7 miles from the airport
- 24,000 square feet of flexible outdoor event space ranging from gardens to beach
- Renovated 15,000 square foot indoor meeting space with grand ballroom and meeting rooms
- The 8,100 square foot flexible Morris Lapidus Grand Ballroom
- 5 private breakout meeting rooms
- Complimentary standard Wi-Fi

Discover Hilton Aruba Caribbean Resort & Casino, where modern elegance blends with the spirit of Aruba. Featuring a breathtaking location on 15 tropical acres along Palm Beach, steps away from nightlife, shopping, and dining, this world-class resort is the perfect place for your next meeting or event.

Experience endless ocean vistas and a diverse selection of bars and restaurants, including our traditional steakhouse, Sunset Grille, Gilligan's Seafood Shack and Mira Solo Lobby Bar.

With a legacy dating back to 1959, the resort features a wide variety of amenities, including water sports, family friendly activities, a nearby butterfly house and exotic wellness journeys in our beachfront eforea™ spa.



**HILTON ARUBA CARIBBEAN
RESORT & CASINO**

[HILTONARUBA.COM](https://www.hiltonaruba.com)

J.E. Irausquin Blvd. 81, Palm Beach, Aruba
800 250 0134 | +297 586 6555
auahh-salesadm@hilton.com

CAPACITIES & DIMENSIONS



	Square Footage	Dimensions W x L	Banquet Style	Theater Style	Square Style	Conference Style	Reception Style	School Style	U-Shape Style	Cabaret Style
Ballrooms										
Salon A, B & C (Ballroom)	8,103'	111' x 73'	560	1000	150	78	900	450	118	280
Salon A	2,701'	37' x 73'	150	380	84	64	300	140	74	75
Salon B	2,701'	37' x 73'	150	380	84	64	300	140	74	75
Salon C	2,701'	37' x 73'	150	380	84	64	300	140	74	75
Salon A & B or B & C	5,402'	74' x 73'	300	722	116	64	600	288	88	150
Meeting Rooms										
Meeting Room 1	665'	19' x 35'	40	46	34	34	40	38	29	20
Meeting Room 2	700'	20' x 35'	40	46	34	34	40	38	29	20
Meeting Room 3	665'	19' x 35'	40	46	34	34	40	38	29	20
Meeting Room 4	1,026'	27' x 38'	50	70	38	38	50	44	35	25
Meeting Room 5	1,026'	27' x 38'	50	70	38	38	50	44	35	25
Foyer	3,200'	-	-	-	-	-	350	-	-	-
Outdoor Venues										
Sunset Terrace	2,278'	34' x 67'	170	-	-	-	200	-	-	85
Miramar North (Grass Lawn)	3,432'	52' x 66'	120	-	-	-	175	-	-	60
Miramar South (Grass Lawn)	2,907'	57' x 51'	120	-	-	-	175	-	-	60
North Pool Deck	9,392'	-	560	-	-	-	645	-	-	280
South Pool Deck	3,724'	-	150	-	-	-	220	-	-	75
Beach Venues										
Beach Aisle	12,600'	90' x 140'	800	-	-	-	1000	-	-	400
South Beach	6,030'	90' x 67'	300	-	-	-	400	-	-	150
Eforea Beach	4,860'	90' x 54'	270	-	-	-	350	-	-	135
Alternative Resort Venues										
Sunset Grille Restaurant	1,617'	49' x 33'	180	-	-	-	325	-	-	-

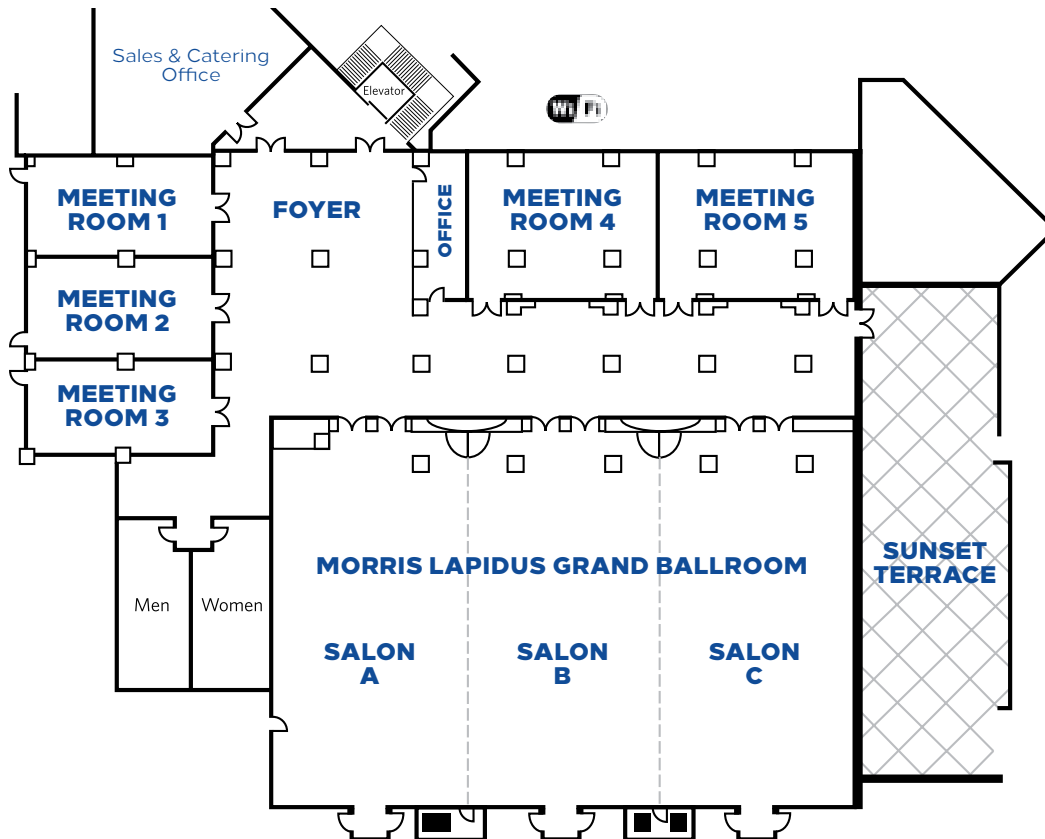

GUEST ROOMS

1. Aruba Tower/Palm Beach Club
2. Bonaire Tower
3. Curaçao Tower

RESTAURANTS & BARS

4. Gilligan's Seafood Shack
5. Castaways Bar
6. Laguna
7. Mira Solo Bar
8. Oscar's Market
9. Sunset Grille

STORES & BOUTIQUES

10. Tropical Breeze
11. Tropical Flavors

AMENITIES & SERVICES

12. Beach
13. Curaçao Lobby
14. De Palm Concierge / Hertz
15. De Palm Pier
16. eforea Spa
17. Fitness Center
18. Main Lobby/Reception
19. Parking Lot
20. North Pool
21. South Pool
22. Towel Hut/Activities Center
23. Red Sail Aruba (Watersports)
24. Bird Garden

MEETING FACILITIES

25. Meeting Rooms (Lower Level)

26. THE CASINO ARUBA