



NEW SITE DEVELOPMENT
In the heart of the Scottish Borders

Enquire Today

www.newbridgecountrypark.co.uk
info@newbridgecountrypark.co.uk
NEWBRIDGE COUNTRY PARK, GLASGOW ROAD , DUMFRIES, DG2 0LF

**LUXURY
PARK HOMES**
AVAILABLE FROM
JUST
£49,995





Newbridge

Country Park

Glamping • Camping • Caravans • Lodges

About Us.....

Newbridge country park is a brand new holiday park development based in acres of stunning countryside and within a stones throw of the market town Dumfries. We are a family owned holiday park with family values at the heart of everything we do..

Dubbed as the "Scottish Riviera" our new park development is the perfect place for your new holiday home. We have a huge range of high quality, UK made, static caravans and park homes for sale.

[View Lodges For Sale](#)

Holiday Forever in your new park home lodge.....

Holiday Homes from just £49,995

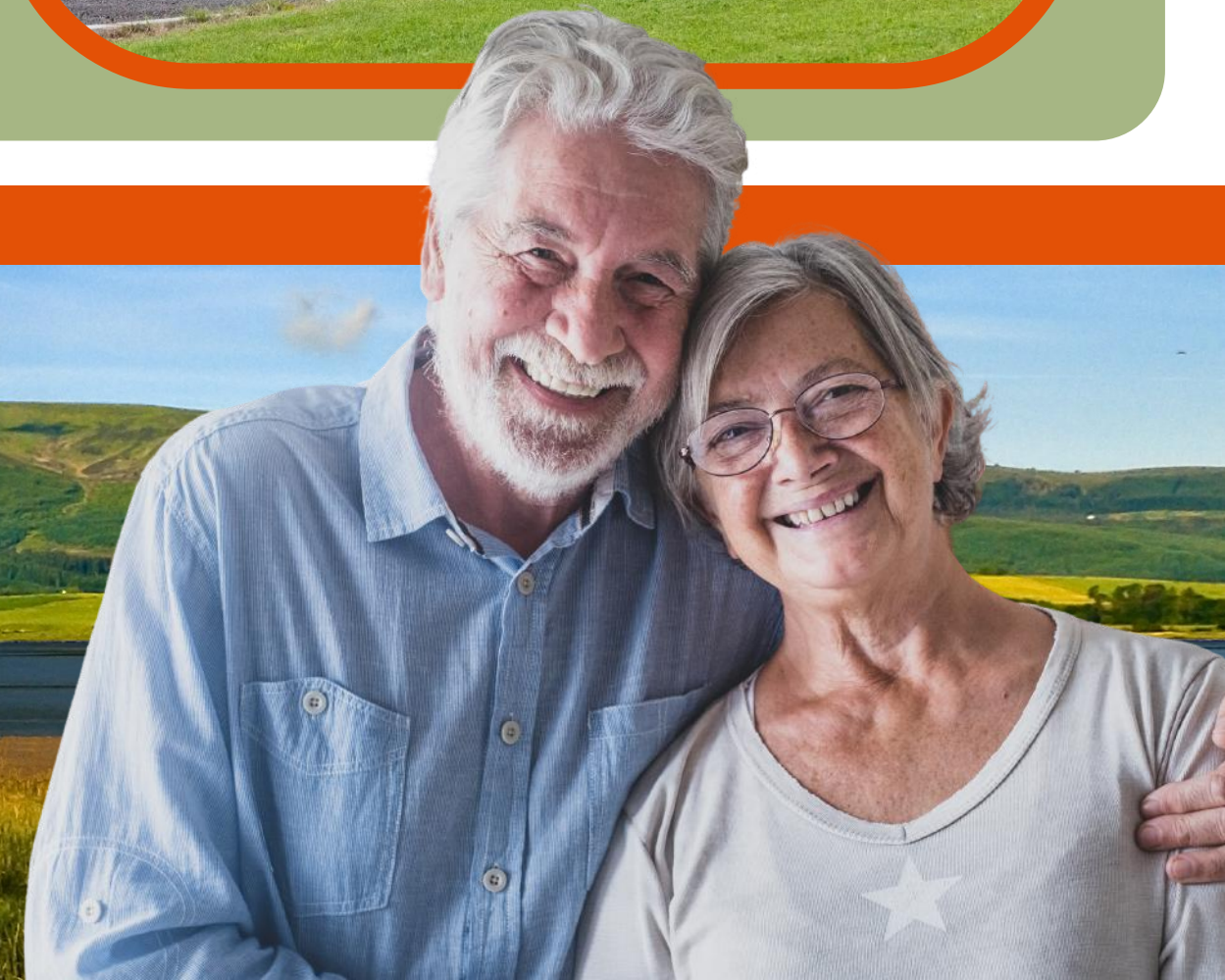

Enquire Today

www.newbridgecountrypark.co.uk

info@newbridgecountrypark.co.uk

NEWBRIDGE COUNTRY PARK, GLASGOW ROAD , DUMFRIES, DG2 0LF

Our Park

Holiday in luxury whenever you need to get away from the hustle and bustle of everyday life.

Owning a park home is a way of life, allowing you the freedom and flexibility to holiday when YOU need to. we have park homes from just £49,995....

Newbridge Country Park is set just a stones throw from the beautiful town of Dumfries, Scotland, Set in acres of countryside. Dumfries and the surrounding areas offer something for everyone. With its quirky shops and local restaurants the town its self is steeped in history. Newbridge is the perfect place for your new holiday home. Its an ideal base for exploring Scotland and Northern England.

Take a Tour of Our Park

**LUXURY
HOLIDAY HOMES**

AVAILABLE

for Pre Order



Enquire Today

www.newbridgecountrypark.co.uk

info@newbridgecountrypark.co.uk

NEWBRIDGE COUNTRY PARK, GLASGOW ROAD , DUMFRIES, DG2 0LF



Holiday Home Sales

**LUXURY
HOLIDAY HOMES**
AVAILABLE FROM
JUST
£49,995

At Newbridge Country Park we have holiday homes, static caravans and lodges for sale & pre order in Dumfries, Scotland on our brand new development. By owning a holiday home in Dumfries you can escape to the park's peace and quiet when you need to relax, recharge and get away from the hustle & bustle of everyday life. Walking, cycling, fishing and many more activities are available within easy access from the park across the Dumfries & Galloway area. With Dumfries town just a stones throw away with its quirky shops, excellent restaurant scene, local markets and more, Newbridge really is the perfect base to explore Scotland and the Scottish Borders.

Take a Tour of Our Park

Enquire Today

www.newbridgecountrypark.co.uk
info@newbridgecountrypark.co.uk
NEWBRIDGE COUNTRY PARK, GLASGOW ROAD , DUMFRIES, DG2 0LF

Holiday Homes FOR SALE



PROPERTY *Details*



The Avantgarde is a very popular model that offers a luxury park home at a very affordable price. As standard this luxury lodge includes patio doors which could give access to your very own decked area (option) and offers great views from your home of the surrounding countryside.

The livingroom is stylish and modern in decor which can also include optional luxury furniture. A modern kitchen with high gloss doors, under unit lighting and many integrated appliances is included as standard and shaker doors plus other upgrades are available as an option. The bathroom includes mirrored cabinets and a dual flush toilet.

AVANTGARDE 2 BED

Lodge features:

- Graphite Georgian Bar Upvc double glazed windows and door/s
- Gas combi central heating system
- Steel pantile roof
- PVC cladding to the exterior
- Lagged pipes
- Exterior lighting
- Feature fire surround with TV point above and twin HDMI
- TV point and HDMI in all bedrooms
- Full gas oven
- Smoked glass cooker hood
- Inbuilt microwave
- Double stand-up fridge freezer
- Domestic interior doors
- Gas ram bed with under bed storage to main bedroom
- Vaulted ceiling throughout
- Thermostatic shower mixer
- Soft touch closing cupboards and drawers
- 2/3 external roof peaks
- Chrome sockets
- Frosted glazed main door
- Carpets and vinyl included
- Beds included
- Soft touch closing kitchen cupboards and drawers
- Built in USB points in kitchen island



Take a tour

AVANTGARDE (40FT X 13FT) FLOOR PLAN

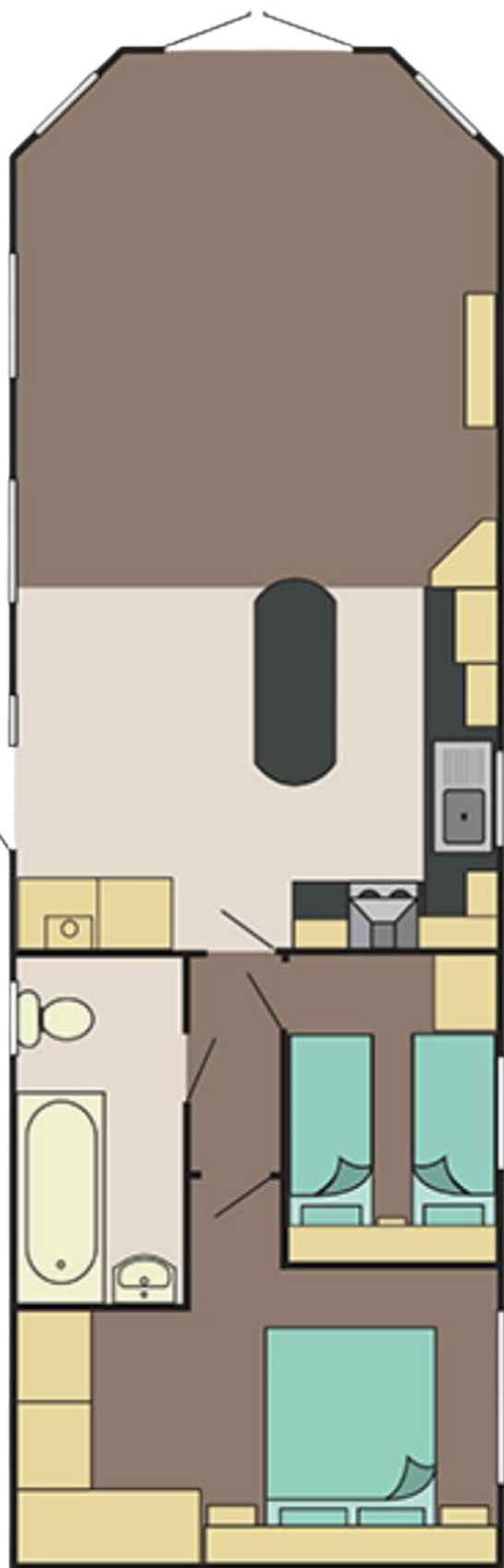

Holiday Homes **FOR SALE**

PROPERTY *Details*

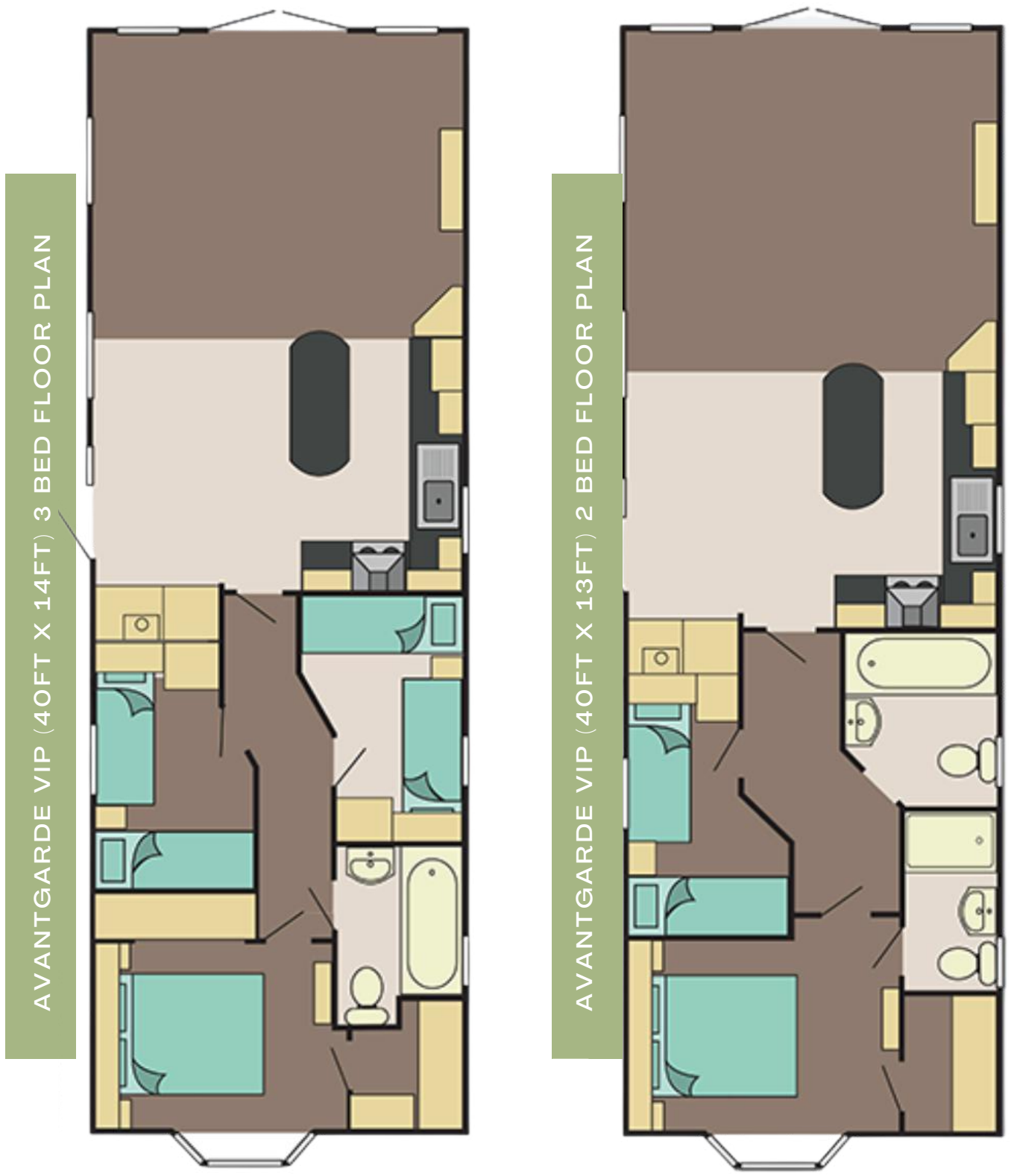

The Avantgarde V.I.P. is a very popular model with a touch of luxury. It is available in both 13ft and 14ft models and includes many extras all built into an affordable price.

It features patio doors to the front giving you direct access to your own deck (option). The living room is wonderfully inviting, with optional luxury furnishing. The bedrooms, include plush headboards. The modern stylish kitchen has high gloss doors with under unit lighting and many integrated appliances. Shaker doors are also available as option.

The Avantgarde V.I.P. has a light and spacious bathroom with a shower above the bath plus a second shower room featuring a large shower enclosure; both include mirrored cabinets and dual flush toilets. If you are looking for a luxury holiday home that has everything the Avantgarde V.I.P. is the home to view.

Lodge features:

- Graphite Georgian Bar Upvc double glazed windows and door/s
- Gas combi central heating system
- Steel pantile roof
- PVC cladding to the exterior
- Lagged pipes
- Exterior light
- Feature fire surround with TV point above and twin HDMI
- TV point and HDMI in all bedrooms
- Full gas oven
- Smoked glass cooker hood
- Integrated microwave
- Double stand-up fridge freezer*
- Domestic interior doors
- Gas ram bed with under bed storage to main bedroom
- Vaulted ceiling throughout
- Thermostatic shower mixer
- Soft touch closing kitchen cupboards and drawers
- Decorative plinth and island LED lights
- 3 external roof peaks
- Chrome sockets
- Beds, mattresses, carpets and curtains included
- Built in USB points in kitchen island
- Frosted glazed main door
- Integrated dishwasher
- En-suite bathroom and walk-in wardrobe in master bedroom

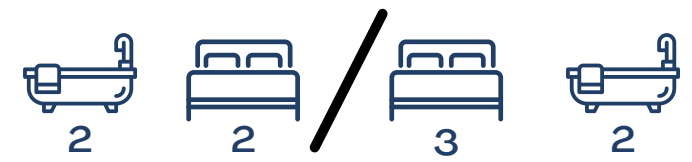

AVANTGARDE VIP



Take a tour

Enquire Today

www.newbridgecountrypark.co.uk
info@newbridgecountrypark.co.uk
 NEWBRIDGE COUNTRY PARK, GLASGOW ROAD, DUMFRIES, DG2 0LF

Holiday Homes FOR SALE

PROPERTY Details



COUNTRYSIDE (40FT X 20FT) 2 BED FLOORPLAN

This residential lodge is designed to give a warm country feeling at a great price. You get all you need in comfort and space from the clever styling. Comfy sofas, separate dining area and well fitted kitchen are all included in the Countryside Lodge along with plenty of storage space including lift up main bed with storage beneath, two shower rooms – one with a bath in the larger lodges, it also has the added advantage of a useful utility room with washer/dryer space, cloak cupboard and door to the exterior.

The open plan living area is spacious and well planned, the large patio doors allowing you access to your outside space easily. Fresh colours have been used to give the unit a light and airy feel to uplift your mood. Well planned and thought through, this unit is a real gem, ideal to start your Lodge experience.

Lodge features:

The Countryside Lodge comes packed with a whole host of standard features and optional extras.

- Pre galvanised I beam chassis
- Upvc double glazed windows & doors
- Extra insulation
- Lagged pipes
- Gas combi central heating system
- Steel pantile roof
- Domestic guttering & downpipes
- Vaulted ceiling throughout
- Feature patio doors to the front
- Dining table & chairs
- Coffee table
- Oven & grill
- Feature electric fire suite
- Stainless steel cooker hood
- Large integrated fridge freezer
- Integrated dishwasher
- Integrated microwave
- Pop up socket tower in island unit
- Feature lighting
- Lift up storage bed in main bedroom
- Ample storage space
- Feature headboards
- Thermostatic shower
- Separate utility room
- Integrated washer/dryer
- En-suite bathroom and walk-in wardrobe in master bedroom



**LUXURY
HOLIDAY HOMES**

AVAILABLE FROM
JUST

£49,995



THE COUNTRYSIDE



Take a tour

Holiday Homes **FOR SALE**



The Chorus

AVAILABLE
FOR
Pre Order



Standard features:

- Central heating
- PVC double glazing
- Extra insulation
- Exterior light
- Low energy lighting
- Sockets with USB port
- Integrated electric oven and grill with 4-ring hob and electric ignition
- Cooker extractor vented to exterior
- L-shape lounge seating with footstool
- Free standing dining table and chairs
- En suite WC to master bedroom
- Feature strip lighting to bedrooms
- Extractor fan to main bathroom/shower room
- Integrated fridge freezer
- Pull out bed to lounge
- Appliance shelf and socket

Upgrade options:

- Front french doors
- Fully galvanised chassis
- Pre galvanised chassis
- Ultrawarm insulation
- Upgrade to graphite windows
- Environmental colours
- Environmental colours complete with graphite windows & doors
- Rigid PVC cladding white windows
- Rigid PVC cladding colour windows
- Canexel cladding white windows
- Canexel cladding coloured windows
- Timber cladding oak windows
- Integrated microwave
- Integrated dishwasher
- Integrated washer/dryer
- Integrated washing machine
- Coffee table
- Lounge scatter cushions
- Plinth heaters & heated towel rails
- Lift up double bed (gas strut) base
- Gazunder twin bed
- TV points & co-ax to bedrooms
- Hallway door
- Standard bedding set
- Deluxe bedding set

The Chorus offers spacious open plan living area, L-shape lounge seating with pull out bed, fully equipped kitchen, free standing dining table/chairs, comfy bedrooms, practical storage solutions throughout – designed from end to end with your leisure in mind.

The Chorus 5 is a perennial favourite with its open plan living area featuring elegant L-shaped sofa with armrest featuring USB charging socket, light wood wall panels and furniture with stylish grey drawer fronts and modern electric fire.

The adjoining dining area has a free standing light wood table top with black metal legs and coordinating black wood dining chairs. This space is separated from the entrance by a built-in shelving unit.

The fitted kitchen in the Chorus 5 is stunning. Its focal point is the copper coloured glass splash back with stainless steel and glass overhead vented extractor. There is an electric oven with grill, 4 ring gas hob and integrated fridge/freezer included as standard.

The Chorus 5 main bedroom is truly stunning. The graphite built in wardrobes are complemented by matching over-bed storage above the kingsize bed. A dressing table with tub style stool and feature strip lighting to the headboard complete a remarkable sleep space.

The second bedroom also features graphite fitted furniture and twin beds. The Chorus 5 has room to sleep the whole family and store all those 'essentials' you need when you take that well deserved break.

The Chorus 5 main bathroom has a large shower cubicle, wash basin with mirrored cabinet above, WC and extractor fan.

With the exception of the 28ft model, all Chorus 5 holiday homes have an en-suite wash basin and WC to the main bedroom.

The Chorus 5 comes complete with central heating, double glazing and extra insulation as standard to guarantee you enjoy your time away whatever the weather has in store.

Sizes

- 28ft x 12ft – 2 bedroom/6 berth
- 32ft x 12ft – 2 bedroom/6 berth
- 36ft x 12ft – 2 bedroom/6 berth
- 39ft x 12ft 2 shower – 2 bedroom/6 berth

Take a tour

Holiday Homes **FOR SALE**



The heritage

AVAILABLE
FOR
Pre Order



The Heritage with its 7ft high ceilings the Heritage interior is a stunner! The open plan living space features 2 and 3 seater sofas with deep button arms. Throughout the use of charming, muted tones and delicate hues are presented across the kitchen/dining area creating an incredibly cool, relaxing environment.

With its 7ft side walls and feature aspect windows, the Heritage 3 has an exceptionally light and airy living space. The freestanding 2 and 3-seater sofas feature luxurious deep button arms and the contemporary fire surround houses a log burner style fire cabinet. The dining area adjoining the kitchen has a light wood freestanding table with 4 cream wood dining chairs.

The spacious open plan kitchen in the Heritage 3 features stunning willow green cabinets and stone-effect contrast tops. This model has an integrated oven and grill, extractor hood and fridge/freezer and black composite sink and mixer tap as standard.

The Heritage 3 benefits from a large master bedroom with king size bed accompanied by a deep buttoned headboard and freestanding furniture in light wood with willow green fronts. The large dressing table comes complete with a tub style stool and circular mirror above.

Available in 2 and 3 bedroom layouts with each bedroom containing two single beds with the same style furniture and headboards as the main bedroom.

The main bathroom features a large shower cubicle, fitted cabinet with wooden splash-back, counter top basin and WC. All models boast an en-suite comprising wash basin and WC to the main bedroom with selected models featuring a shower in addition.

The Heritage 3 now comes in 7 different layouts with 12ft and 13ft widths and lengths from 36ft to 40ft including the two exciting new twin shower configurations. This is the ideal choice for those wanting a versatile, spacious holiday home.

Sizes

- 36ft x 12ft – 2 bedroom/6 berth
- 38ft x 12ft – 2 bedroom/6 berth
- 39ft x 13ft 2 shower – 2 bedroom/6 berth
- 40ft x 12ft – 3 bedroom/8 berth
- 38ft x 13ft – 2 bedroom/6 berth
- 39ft x 13ft 2 shower – 2 bedroom/6 berth
- 40ft x 13ft – 3 bedroom/8 berth

Take a tour

Standard features:

- Matt finish châteaux grey cladding
- Low energy lighting
- Feature aspect windows
- Integrated fridge freezer
- Free standing two and three-seater suite with deep button arms
- Pull out sofa bed to lounge
- Electric fire
- Feature fire cabinet
- Low energy lighting
- Sockets with USB to bedrooms, kitchen and lounge
- Freestanding dining table and chairs
- Re-circulating electric extractor hood
- Integrated electric oven and grill with 4 ring hob with electric ignition
- Over bed reading lights
- Feature fire cabinet
- TV point to master bedroom
- Feature dining pendant light
- Carpet with underlay
- En suite bathroom to all models
- Extractor fan to main bathroom/shower room
- Exterior light

Popular Selected Options

- Winter warm pack
- Ultrawarm insulation
- Front french doors
- Fully galvanised chassis
- Pre galvanised chassis
- Upgrade to graphite windows
- Environmental colours
- Environmental colours complete with graphite windows & doors
- Rigid PVC cladding white windows
- Rigid PVC cladding colour windows
- Canexel cladding white windows
- Canexel cladding coloured windows
- Timber cladding oak windows
- Integrated microwave
- Integrated dishwasher*
- Integrated washer/dryer*
- Integrated washing machine*
- Wine cooler (13ft models only)
- Coffee table
- Lounge footstool
- Lounge scatter cushions
- Wall mounted tv point in lounge
- Plinth heaters & heated towel rails
- Lift up double bed (gas strut) base
- Gazunder twin bed
- TV point to twin bedroom
- Standard bedding set
- Deluxe bedding set

Upgrade options:

Holiday Homes **FOR SALE**



The Debonair



Standard features:

- Free standing two and three-seater suite complete with stag and bolster cushions
- Free standing table and chairs
- Pull out bed to lounge
- Integrated electric oven and grill with 4-ring gas hob and electric ignition
- Sockets with USB port
- Low energy lighting
- Recirculating electric cooker hood
- Designer interior lighting throughout
- En-suite WC to master bedroom
- Integrated fridge freezer
- Exterior fan to main bathroom/shower room
- Appliance shelf and socket

The Debonair, a stunning example of how traditional features can successfully blend with the best in modern design.

The mix of warm muted colours and carefully toned fabrics create a relaxing country home feel throughout the living, kitchen/dining area, whilst fixtures and fittings deliver the best in style, efficiency and convenience.

The Debonair 8 interior is an epitome of country home living.

The lounge has freestanding 2 and 3 seater settees with homely fabrics and contrasting stag and bolster cushions. The living room also features a log-burner style electric fire in a traditional mantelpiece setting.

The farmhouse style dining table is complemented by matching chairs which continue the country theme.

The Debonair 8 has a fully fitted farmhouse-style kitchen benefiting from an integrated oven and 5 ring gas hob, electric cooker hood and integrated fridge freezer. The kitchen units are a mixture of standard and glass fronted doors for an added touch of elegance.

The main bedroom continues the traditional styling with beautiful built in furniture and kingsize bed. Light floods in to the bedroom through the large three-quarter height window and the bedroom is completed with en-suite comprising wash basin and WC. The second bedroom features two single beds and a built in wardrobe with over bed storage.

There is also a 3 bedroom model available giving extra sleeping options.

The main shower room has a large shower cubicle, stylish countertop wash basin with storage cabinet below, WC and external extractor fan.

The en-suite to the main bedroom has a wash basin with mirror above and WC.

Due to its great popularity, there are now 7 variations of the Debonair 8 available. The 12ft and 13ft widths come in lengths between 36ft to 40ft including two exciting new twin shower configurations.

Sizes

- 36ft x 12ft – 2 bedroom/6 berth
- 38ft x 12ft – 2 bedroom/6 berth
- 38ft x 12ft – 3 bedroom/8 berth
- 40ft x 12ft 2 shower – 2 bedroom/6 berth
- 38ft x 13ft – 2 bedroom/6 berth
- 40ft x 13ft 2 SHOWERS – 2 bedroom/6 berth
- 40ft x 13ft – 3 bedroom/8 berth

Take a tour

AVAILABLE FOR
Pre Order

Upgrade options:

- Winter warm pack
- Ultrawarm insulation
- Front sliding doors
- Fully galvanised chassis
- Pre galvanised chassis
- Upgrade to graphite windows
- Environmental colours
- Environmental colours complete with graphite windows & doors
- Rigid PVC cladding white windows
- Rigid PVC cladding colour windows
- Canoxel cladding white windows
- Canoxel cladding coloured windows
- Timber cladding oak windows
- Integrated microwave
- Integrated dishwasher
- Integrated washer/dryer
- Integrated washing machine
- Wine cooler in 13ft models
- Coffee table
- Lounge footstool
- Wall mounted TV point in lounge
- Plinth heaters & heated towel rails
- Lift up double bed (gas strut) base
- Gazunder twin bed
- TV points & co-ax to bedrooms
- Standard bedding set
- Deluxe bedding set

Holiday Homes FOR SALE



The Onyx

THE ONYX 5 LIVING ROOM MAKES AN INSTANT IMPRESSION WITH ITS CHIC LOOK. THE L-SHAPED SOFA AND LARGE FEATURE ARMCHAIR CAN SEAT THE WHOLE FAMILY IN COMFORT. THE FEATURE LIGHT WOOD WALL PANEL AND BUILT IN FURNITURE IS COMPLEMENTED BY AN ELECTRIC FIRE WITH STYLISH BLACK NICKEL SURROUND.

THE COSY DINING AREA IS SEPARATED FROM THE LOUNGE AND HAS A MODERN DINING TABLE WITH FOUR LADDERBACK CHAIRS. THE KITCHEN ALSO IN LIGHT OAK HAS CHAMPAGNE COLOURED LOWER DOOR FRONTS. IT IS WELL-EQUIPPED WITH AN INTEGRATED OVEN, GRILL AND 4-RING HOB COMPLETE WITH EXTRACTOR HOOD. AN INTEGRATED FRIDGE/FREEZER AND APPLIANCE SHELF WITH SOCKET FINISH OFF THIS IMPRESSIVE KITCHEN.

THE MAIN BEDROOM IS ABSOLUTELY STUNNING WITH LIGHT WOOD FURNITURE AND KINGSIZE BED. THE OUTSTANDING FEATURE OF THE BEDROOM IS THE UPHOLSTERED HEADBOARD. A LARGE DRESSING TABLE IS COMPLEMENTED BY A CUBE STOOL AND THE ROOM BENEFITS FROM A FITTED WARDROBE.

AVAILABLE IN 2 AND 3 BED MODELS, ADDITIONAL BEDROOMS ALSO FEATURE STYLISH UPHOLSTERED HEADBOARDS AND WARDROBES.

THE MAIN BATHROOM HAS A LARGE SHOWER CUBICLE, WASH BASIN, WC AND EXTRACTOR FAN. ALL MODELS FEATURE AN EN-SUITE TO THE MAIN BEDROOM. 2-BED MODELS HAVE WASH BASIN AND WC WHILE THE 3 BEDROOM LAYOUT FEATURES A WASH BASIN, WC AND EXTRACTOR FAN.

THE ONYX 5 IS ABSOLUTELY PERFECT FOR COUPLES OR FAMILIES WANTING A STYLISH, GREAT VALUE HOLIDAY HOME. IT HAS A BRIGHT AND AIRY INTERIOR MAKING AN INSTANT IMPRESSION - PERFECT FOR A SUMMER HOLIDAY OR SHORT BREAK AT ANY TIME OF YEAR.

SIZES
36FT x 12FT - 2 BEDROOM/6 BERTH
38FT x 12FT - 2 BEDROOM/6 BERTH
38FT x 12FT - 3 BEDROOM/8 BERTH

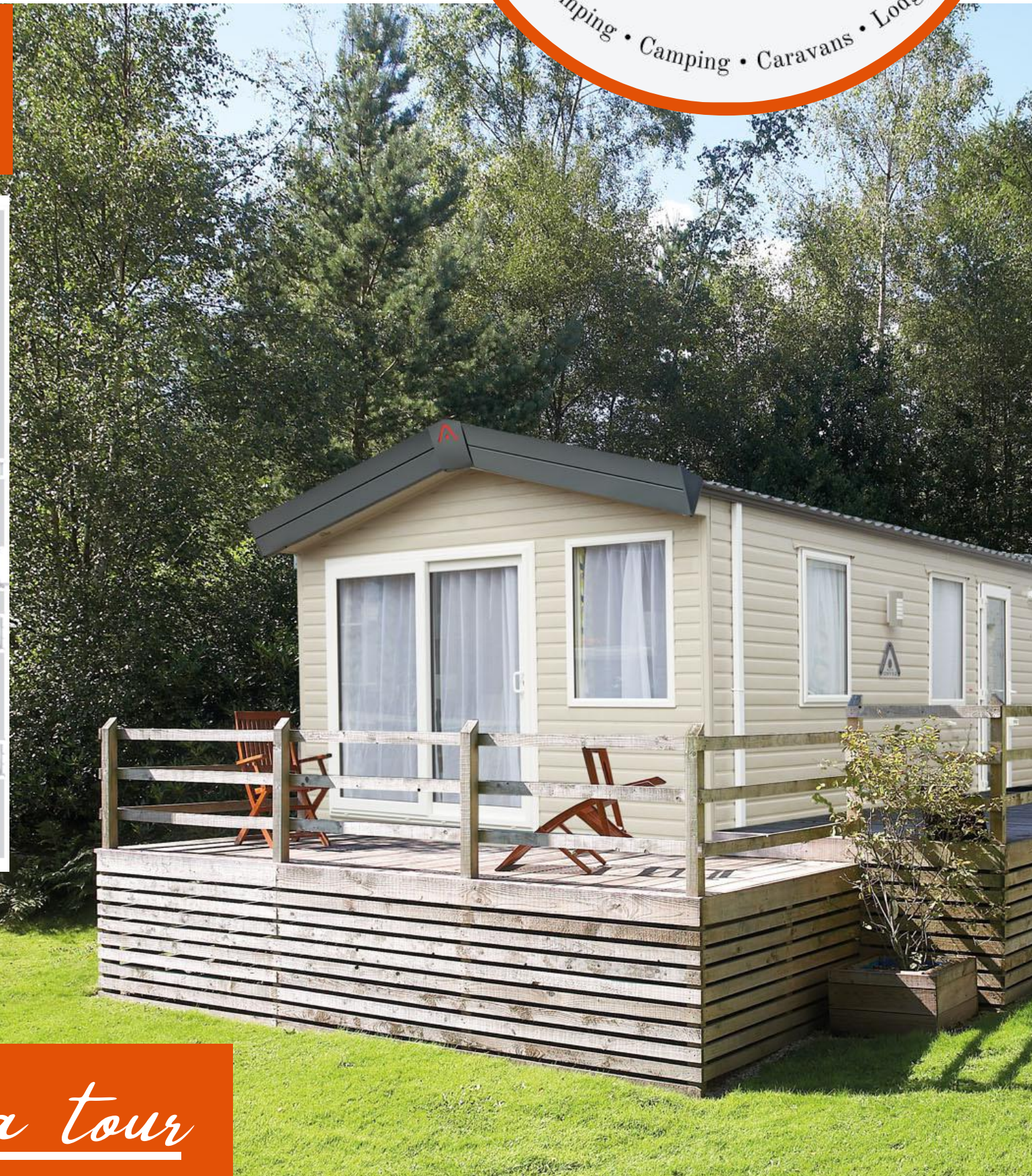

Take a tour

Standard features:

- EN SUITE WITH BATH TO 38 X 12 - 2 BEDROOM MODEL
- EN SUITE WC TO 36 X 12 - 2 BED AND 40 X 12 - 3 BEDROOM MODEL
- EXTERIOR LIGHT
- PULL OUT BED TO LOUNGE
- SOCKETS WITH USB PORT
- LOW ENERGY LIGHTING
- FREE STANDING DINING TABLE AND CHAIRS
- RECIRCULATING ELECTRIC EXTRACTOR HOOD
- INTEGRATED OVEN AND GRILL WITH 4 RING HOB AND ELECTRIC IGNITION
- INTEGRATED FRIDGE FREEZER
- APPLIANCE SHELF AND SOCKET
- OVER BED WALL LIGHTS
- L-SHAPE SEATING AND FEATURE ARMCHAIR
- EXTRACTOR FAN TO MAIN BATHROOM/SHOWER ROOM

Upgrade options:

- WINTER WARM PACK
- ULTRAWARM INSULATION
- FRONT SLIDING DOORS
- FULLY GALVANISED CHASSIS
- PRE GALVANISED CHASSIS
- UPGRADE TO GRAPHITE WINDOWS
- ENVIRONMENTAL COLOURS
- ENVIRONMENTAL COLOURS COMPLETE WITH GRAPHITE WINDOWS & DOORS
- RIGID PVC CLADDING WHITE WINDOWS
- RIGID PVC CLADDING COLOUR WINDOWS
- CANEXEL CLADDING WHITE WINDOWS
- CANEXEL CLADDING COLOURED WINDOWS
- TIMBER CLADDING OAK WINDOWS
- INTEGRATED MICROWAVE
- INTEGRATED DISHWASHER
- INTEGRATED WASHER/DRYER
- INTEGRATED WASHING MACHINE
- COFFEE TABLE
- LOUNGE SCATTER CUSHIONS
- WALL MOUNTED TV POINT IN LOUNGE
- PLINTH HEATERS & HEATED TOWEL RAILS
- LIFT UP DOUBLE BED (GAS STRUT) BASE
- GAZUNDER TWIN BED
- TV POINTS & CO-AX TO BEDROOMS
- SHOWER OVER BATH IN 38 X 12-2 BED
- SHOWER IN LIEU OF BATH IN 38 X 12-2 BED ONLY
- STANDARD BEDDING SET
- DELUXE BEDDING SET

Join the Newbridge family.....

REQUEST A CALL BACK
OR BOOK A
VIEWING TODAY

WE HAVE PARK HOMES,
STATIC CARAVANS AND
LODGES FOR SALE IN DUMFRIES
TO SUIT ALL BUDGETS AND
STYLES

Contact Us



Country Park

Glamping • Camping • Caravans • Lodges



Enquire Today

www.newbridgecountrypark.co.uk

info@newbridgecountrypark.co.uk

NEWBRIDGE COUNTRY PARK, GLASGOW ROAD , DUMFRIES, DG2 0LF